

# MORGAN STREET ELEVATED STATION



**City of Chicago**  
Richard M. Daley, Mayor

**Department of Transportation**  
Bobby L. Ware, Commissioner

**Division of Engineering**  
John Yonan, P.E., Deputy Commissioner



City of Chicago  
Richard M. Daley, Mayor

**MORGAN STREET ELEVATED STATION**



# project site



City of Chicago  
Richard M. Daley, Mayor

**MORGAN STREET ELEVATED STATION**



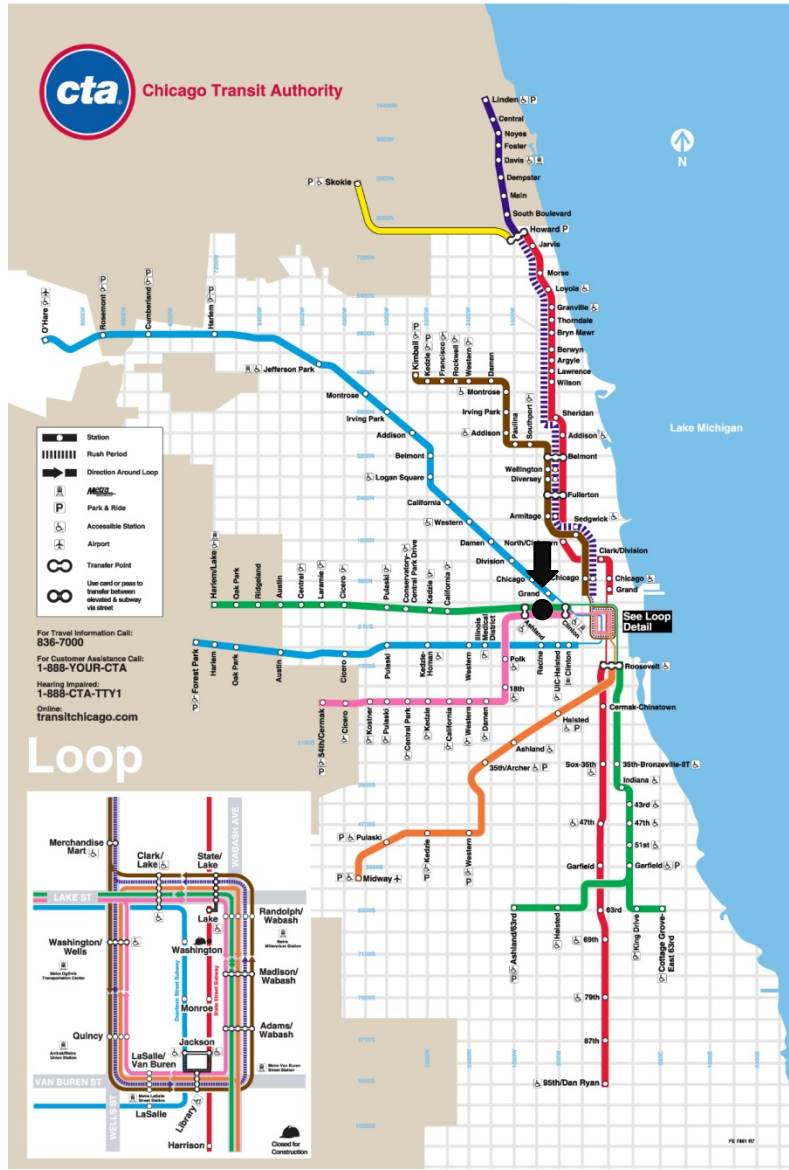

CTA System Map



City of Chicago  
 Richard M. Daley, Mayor

MORGAN STREET ELEVATED STATION



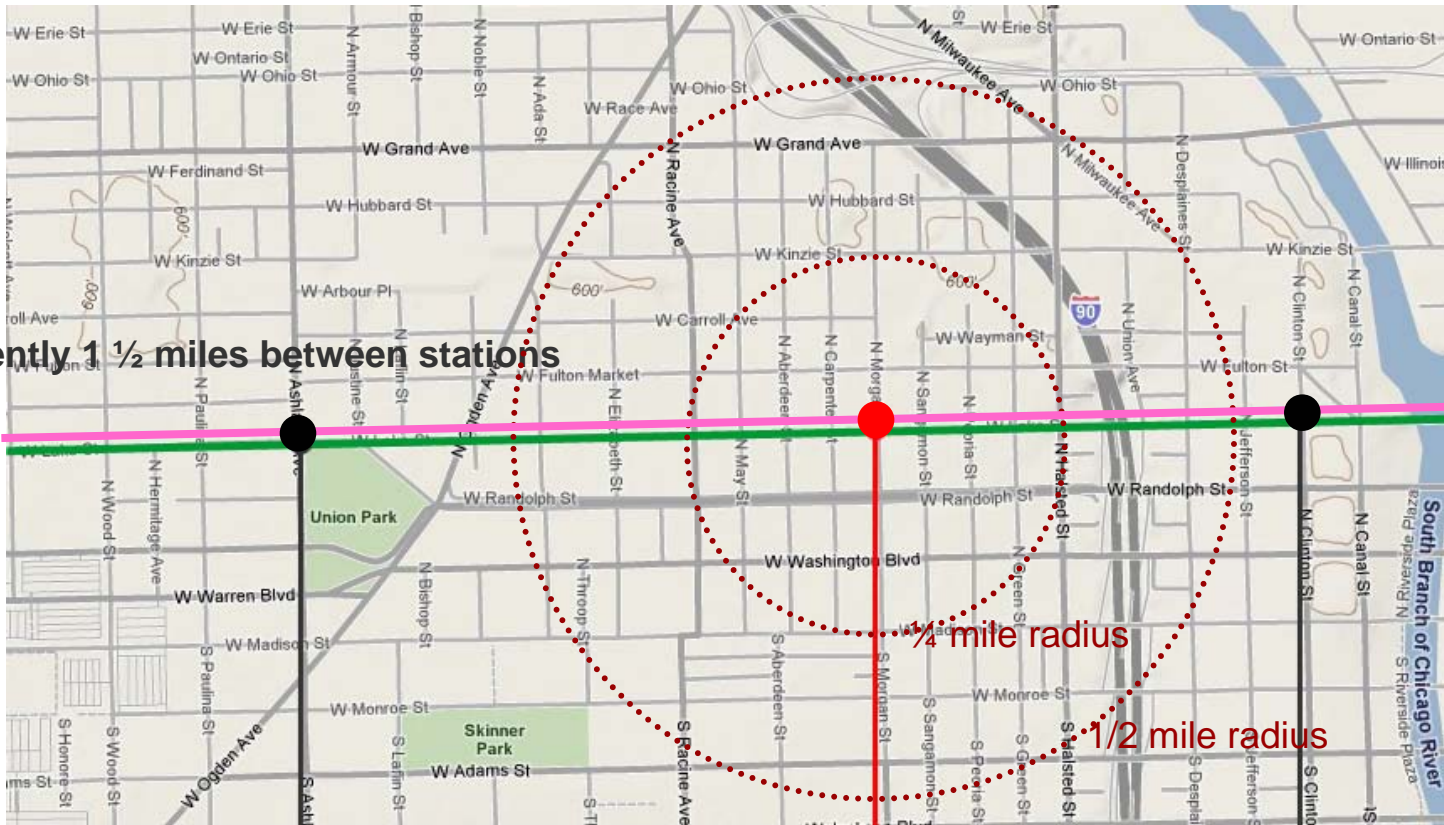

currently 1 1/2 miles between stations

1/4 mile radius

1/2 mile radius

ASHLAND

MORGAN

CLINTON

KEY

● EXISTING STATION

● PROPOSED STATION



City of Chicago  
Richard M. Daley, Mayor

MORGAN STREET ELEVATED STATION



# program



City of Chicago  
Richard M. Daley, Mayor

**MORGAN STREET ELEVATED STATION**



# OBJECTIVES FOR STATION

## Community Priorities

- Provide access to industrial and commercial districts
- Provide direct access to downtown for residents in the proximity
- Accessibility
- Provide landscaping and other site amenities

## LEED

- Incorporate sustainable elements

## Constructability

- Phased construction for continuous Green / Pink Line operations
- Modular materials for ease of construction

## Maintenance

- Material durability
- Ease of maintenance

## Safety and Security

- Good lighting
- Protection at grade from traffic
- Surveillance equipment



City of Chicago  
Richard M. Daley, Mayor

**MORGAN STREET ELEVATED STATION**



# DESIGN CONSIDERATIONS

- **Enhance line and local identity**
- **Design a functional space consistent with Chicago's rich architectural tradition**
- **Accommodate CTA riders arriving by bicycle**
- **Weather protection**
- **Enclosed stairs and elevators**
- **Ease of Maintenance**
- **Elevators for passengers with disabilities**



City of Chicago  
Richard M. Daley, Mayor

**MORGAN STREET ELEVATED STATION**



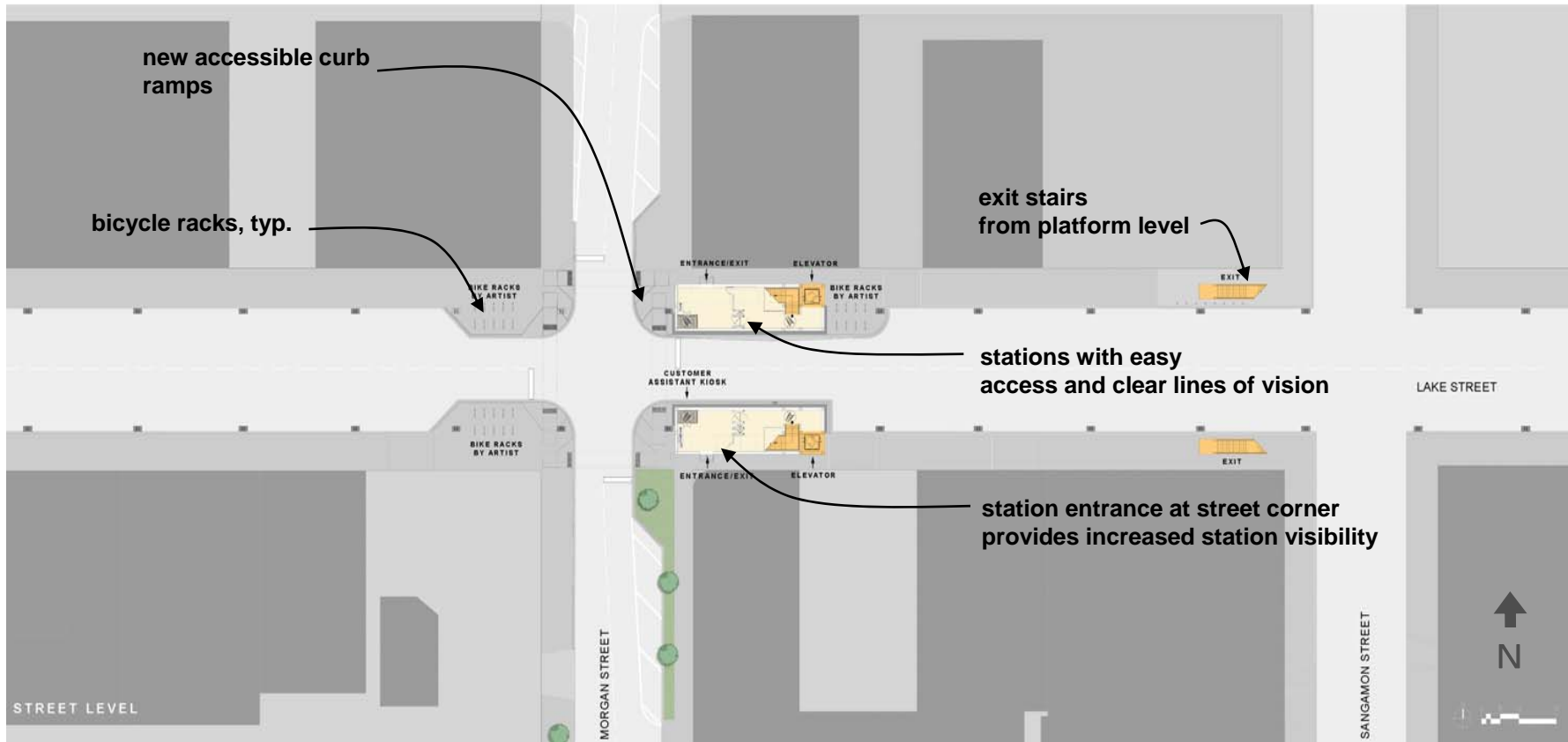

ground level site plan



City of Chicago  
Richard M. Daley, Mayor

# MORGAN STREET ELEVATED STATION





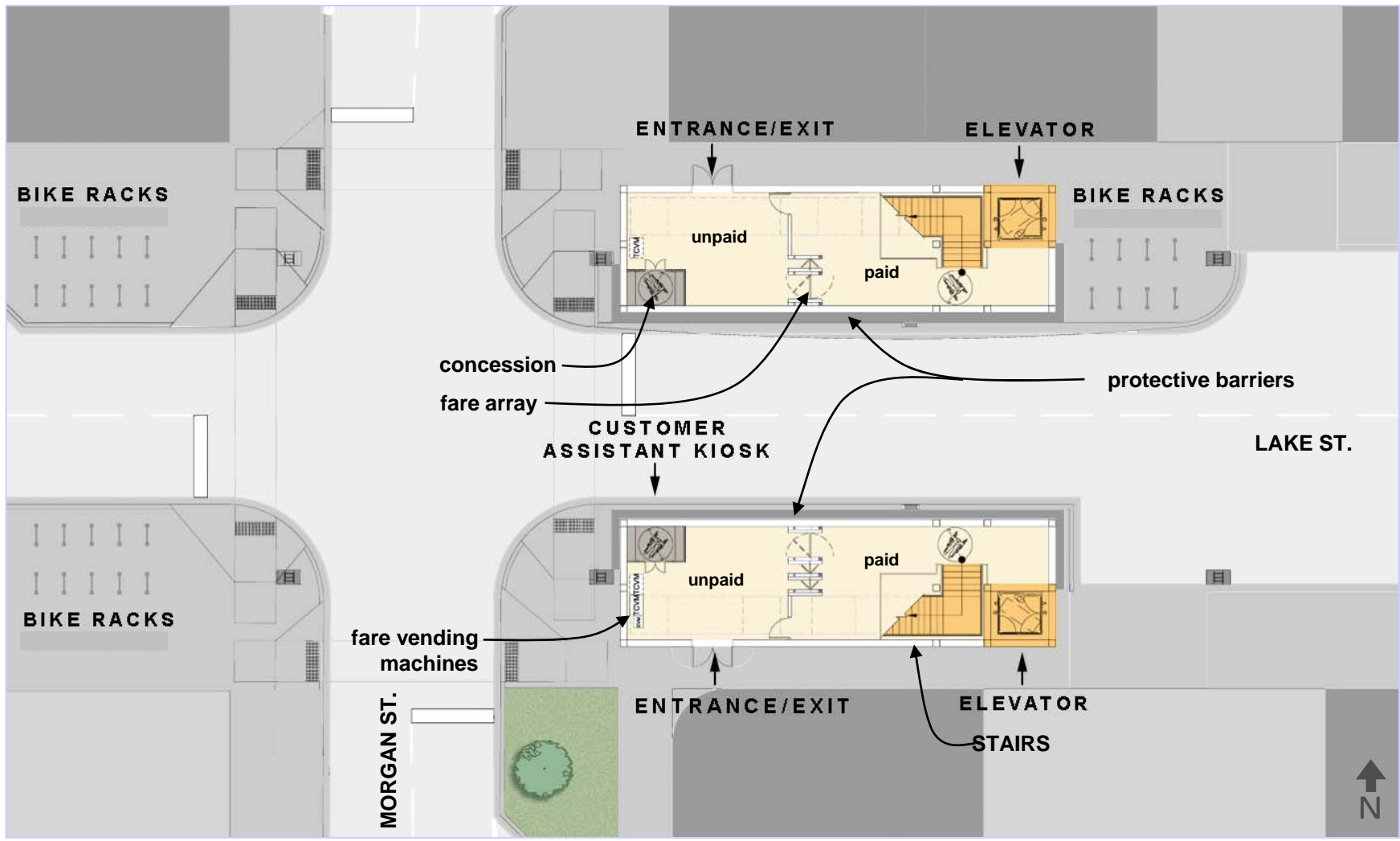

ground level



City of Chicago  
Richard M. Daley, Mayor

# MORGAN STREET ELEVATED STATION



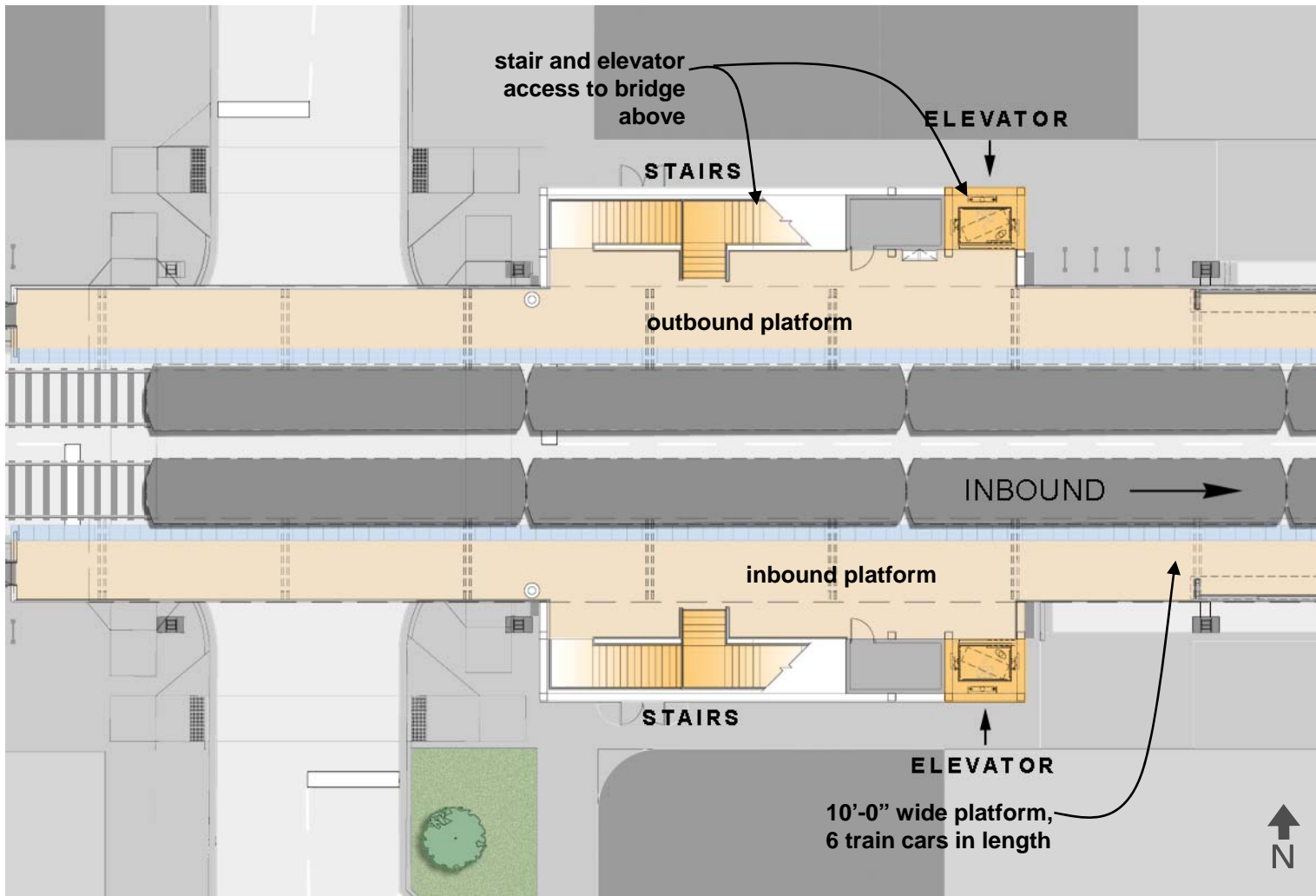

platform level



City of Chicago  
Richard M. Daley, Mayor

# MORGAN STREET ELEVATED STATION





platform level site plan



City of Chicago  
Richard M. Daley, Mayor

# MORGAN STREET ELEVATED STATION



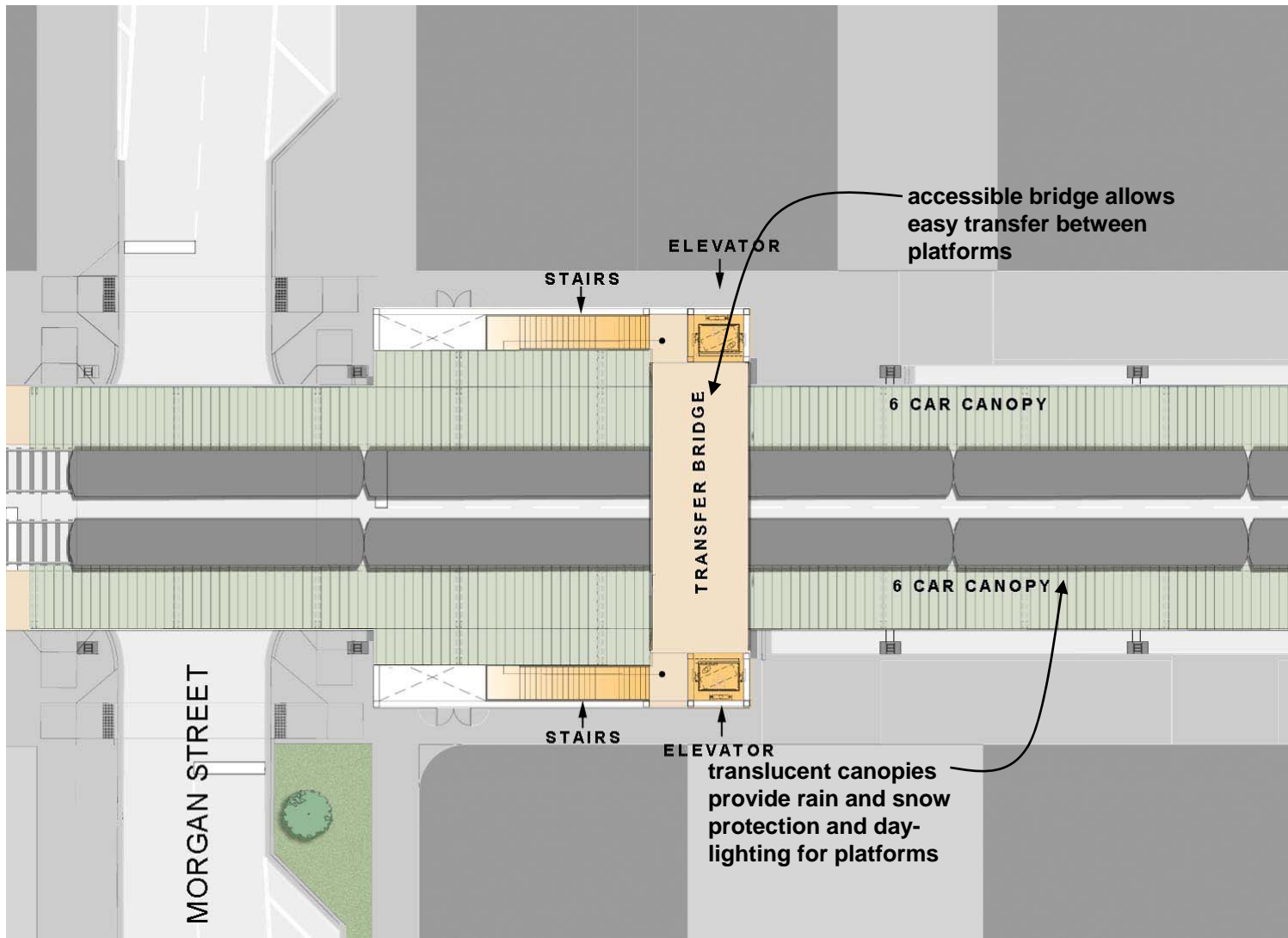

bridge level



City of Chicago  
Richard M. Daley, Mayor

# MORGAN STREET ELEVATED STATION



# finishes



City of Chicago  
Richard M. Daley, Mayor

**MORGAN STREET ELEVATED STATION**



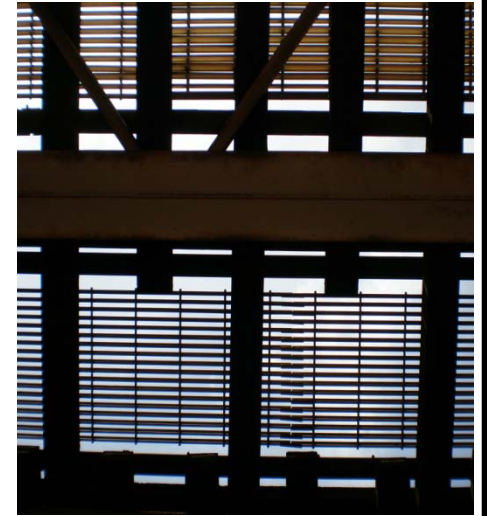

existing textures, finishes and materials found in the area



elements used in CTA Stations



City of Chicago  
Richard M. Daley, Mayor

# MORGAN STREET ELEVATED STATION





contemporary architectural language around project site



City of Chicago  
Richard M. Daley, Mayor

## MORGAN STREET ELEVATED STATION





precedents for canopy concepts, materials, and design solutions throughout the industrial district



City of Chicago  
Richard M. Daley, Mayor

**MORGAN STREET ELEVATED STATION**







contemporary translation of the district's industrial character



City of Chicago  
Richard M. Daley, Mayor

## MORGAN STREET ELEVATED STATION





sidewalk view



City of Chicago  
Richard M. Daley, Mayor

# MORGAN STREET ELEVATED STATION





platform view



City of Chicago  
Richard M. Daley, Mayor

## MORGAN STREET ELEVATED STATION





aerial view

Ross Barney Architects



City of Chicago  
Richard M. Daley, Mayor

## MORGAN STREET ELEVATED STATION



## Traffic impacts:

- Lake Street to see lane reductions
- one lane of traffic eastbound on Lake St. will be maintained
- some overnight closures will be required
- parking restrictions in construction area; signs will indicate restrictions

## Building impacts:

- access to local businesses and residences will be maintained
- some temporary sidewalk closures will occur
- some temporary crosswalk closures will occur

CDOT will monitor vehicular and pedestrian traffic throughout the duration of construction.

CDOT will work to minimize the impact of construction on residents, businesses, motorists and pedestrians.



City of Chicago  
Richard M. Daley, Mayor

**MORGAN STREET ELEVATED STATION**



# PROJECT SCHEDULE

- Contract Award : Spring 2010
- Start of Construction : Mid 2010
- Estimated Completion: Mid 2012



City of Chicago  
Richard M. Daley, Mayor

**MORGAN STREET ELEVATED STATION**

