

ROOSEVELT & KOSTNER RFP COMMUNITY PRESENTATIONS

CITY OF CHICAGO DEPARTMENT OF PLANNING & DEVELOPMENT (DPD)

February 23 & 24, 2021

Agenda

1 Welcome & Overview (5:30 – 5:40)

2 Quick Recap (5:40 – 5:50)

3 Respondent Team #1 (5:50 – 6:20)

Video Presentation (8 min) | Q&A (22 min)

4 Respondent Team #2 (6:20 – 6:50)

Video Presentation (8 min) | Q&A (22 min)

5 Respondent Team #3 (6:50 – 7:20)

Video Presentation (8 min) | Q&A (22 min)

6 Next Steps (7:20 – 7:30)

Roosevelt & Kostner Community Presentations

February 23 & 24, 2021

Welcome!

Thank you for joining us as we continue the **Roosevelt & Kostner Request for Proposals (RFP)** process.

The 4300 W. Roosevelt Road RFP, which **reactivates a long-vacant industrial site**, is a key element of the **INVEST South/West initiative** – a groundbreaking effort to coordinate investment on the City’s South and West Sides.

The City needs your feedback on the proposals you’ll see today to **help us advance to selecting a winning entry**.



City of Chicago
Lori E. Lightfoot, Mayor

Request for Proposals
4300 W. Roosevelt Road



Department of Planning and Development
Maurice D. Cox, Commissioner
City Hall Room 1000
121 N. LaSalle St.
Chicago, IL 60602

September 28, 2020

Roosevelt & Kostner Community Presentations

February 23 & 24, 2021

What we hope to accomplish today

1

Meet Respondent Teams



2

Learn About Proposals



3

Ask Questions & Provide Feedback



Roosevelt & Kostner Community Presentations

February 23 & 24, 2021

RFP RECAP

Roosevelt & Kostner Community Presentations

February 23 & 24, 2021

RFP Timeline

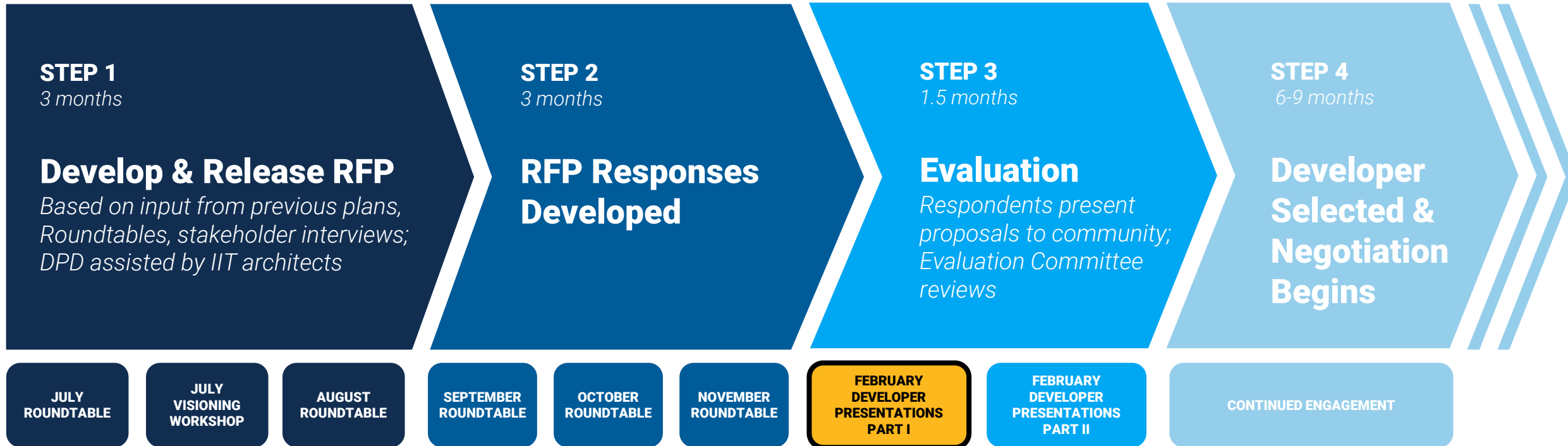

Roosevelt & Kostner Community Presentations

February 23 & 24, 2021

Roosevelt & Kostner Site

- Site has been vacant for decades
- Ald. Scott & DPD have received numerous proposals for the Site
- Use the ISW RFP to create competitive, transparent process

RFP Has Two Main Goals:

- 1) Job & Wealth Creation**
- 2) Be A Good Neighbor**

Urban Design Suggestions



TRANSITION FROM INDUSTRIAL TO NEIGHBORING RESIDENTIAL

Use landscaping, fencing, and smaller buildings, to the extent possible, to create. The Site is at the eastern end of the industrial corridor and must be a “good neighbor” for the residential communities to the north, east, and south.

FOCUS COMMUNITY AMENITIES ON ROOSEVELT ROAD

Non-industrial uses can be focused along Roosevelt Road in order to catalyze amenities along the area’s major commercial corridor.

CREATE SPACES FOR MULTIPLE USERS

Use multiple sizes of buildings and multi-tenant spaces in order to support a variety of businesses. Smaller spaces can increase the participation of local entrepreneurs and small businesses in the economic revitalization of the area.

CREATE OPEN SPACE NEAR POTENTIAL GREENWAY

The City and community are beginning initial analysis about the potential of a “rails with trails” greenway along the current CSX Altenheim line rail corridor. As a major potential greenspace and community amenity, the Site should create or reserve open space near the rail line

1. Job & Wealth Creation

*Beyond 26/6 MWBE requirements

Local Hiring & Ownership Strategy

- Number of Jobs (FTE)
 - Number of Local Jobs
 - *Job Access for Hard to Employ*
- Wages
- Opportunity for Advancement & Training
 - Labor / Skill / Management
- Local Wealth Building Opportunities
 - *Employee Ownership & Co-Ops*
 - *Business Partnerships*

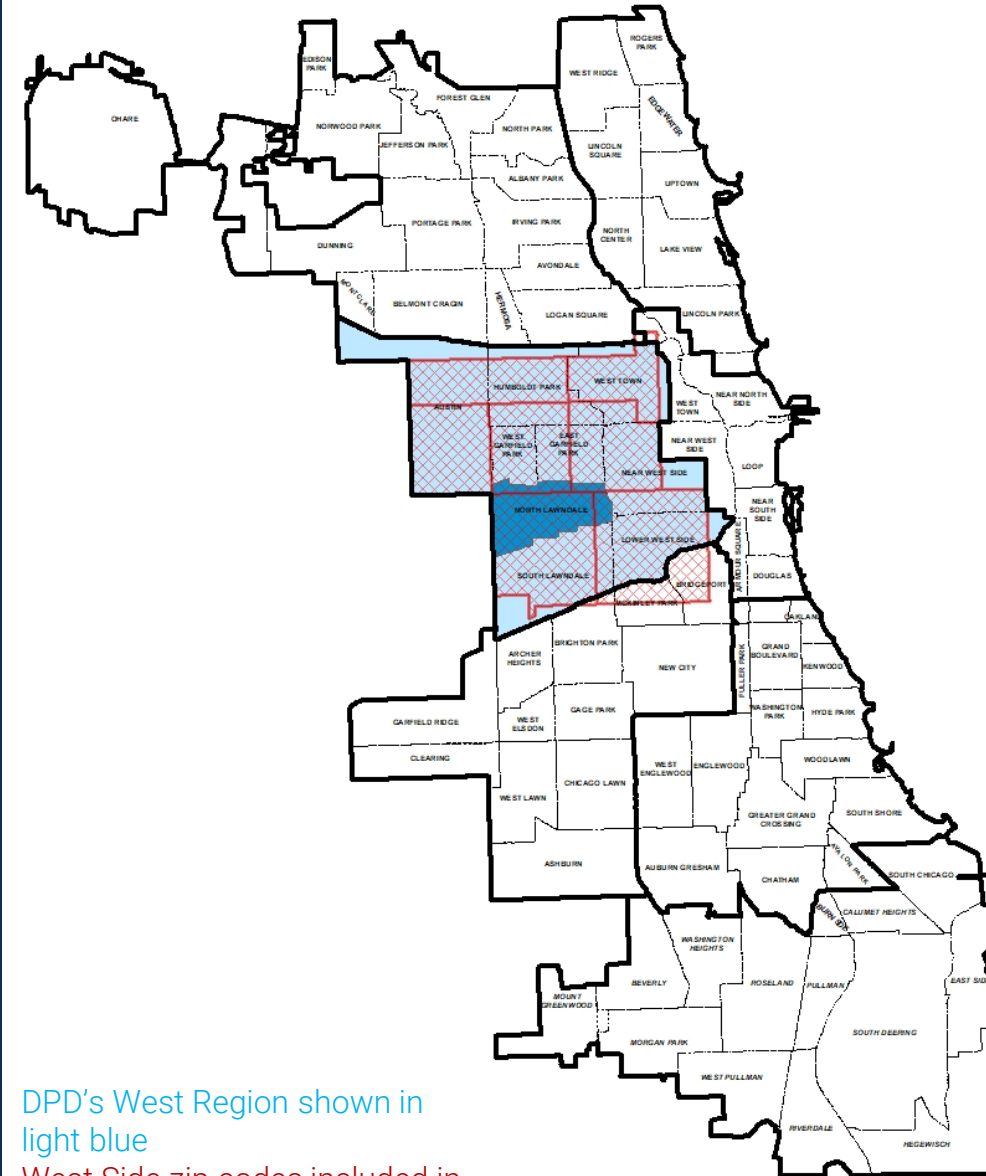





DPD's West Region shown in light blue

West Side zip codes included in RFP criteria shown in red hatch

2. Be A Good Neighbor

- Meaningful local involvement
 - Partnership with Local Orgs & Biz
 - Development team / tenants / partners
- Environmental / Noise / Truck Concerns
- Promote a high-quality built environment
 - **Commitment to Design Excellence**
 - Connection to “rails with trails”, even if in future

Respondent Teams

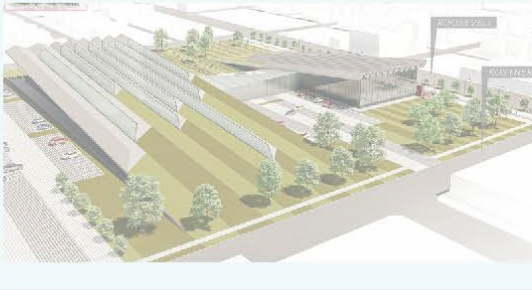
Tuesday, Feb 23 5:30–7:30pm		Wednesday, Feb 24 5:30–7:30pm	
548 Development & Related Midwest			McCaffery, KMA Companies, A Safe Haven
Lawndale United (MK Asset Mgmt, CNI Group, East Lake Mgmt)			Matanky Development & Safeway Construction
Cubs Charities & Pritzker Realty			RK5 (McLaurin, JGMA BOWA, Mckenzie Mgmt, Art West, & partners)

Roosevelt & Kostner Community Presentations

February 23 & 24, 2021

Today's Process

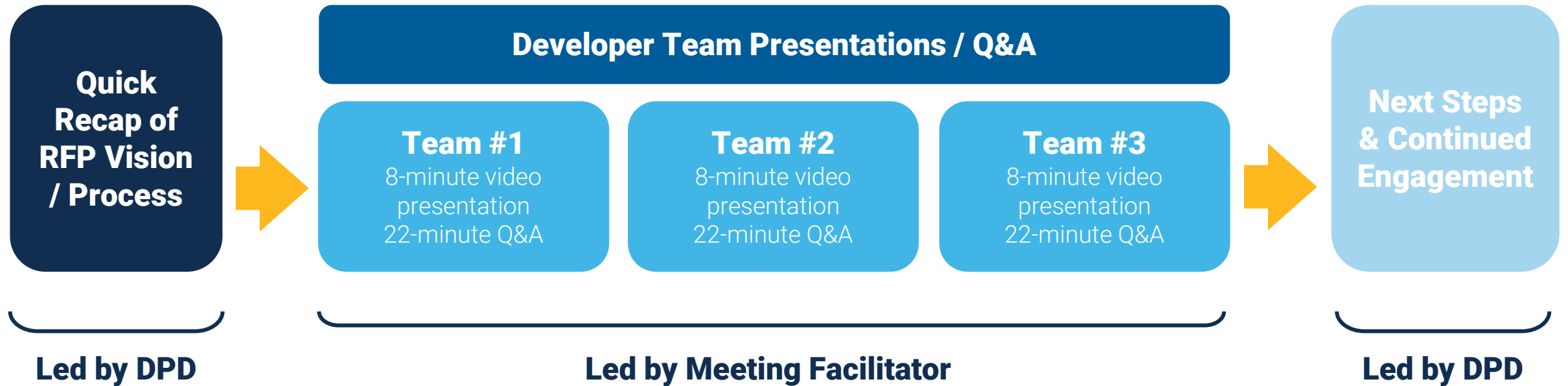

Roosevelt & Kostner Community Presentations

February 23 & 24, 2021

Community Presentations: What to keep in mind



1. Overall impression of each proposal

2. What excites you? What concerns you?

3. Community Wealth Building

Involvement of minority-owned team members

Promotion of local business & ownership

Local hiring for quality jobs

Prior West Side experience

4. Competence and Appropriateness

Uses and spaces

Reflective of community priorities

High-quality design

Development / design team experience and abilities

City's Evaluation Criteria

1

**Does the proposal build
Community Wealth?**

30% of total score

- Community Partnerships
- Commitment to Equity
- Local Hiring
- Promoting Small Businesses

2

**Is the proposal a great
example of Professional
Competence?**

40% of total score

- Professional Experience
- Design Excellence
- Responding to Community Priorities
- Innovation and Creativity

3

**Is the proposal
Economically Feasible?**

30% of total score

- Total Project Cost
- Public Assistance Requested
- Financial Qualifications



Community Presentation Feedback / Online Survey Results

Roosevelt & Kostner Community Presentations

February 23 & 24, 2021

How feedback will be incorporated

1 Comment Synthesis

DPD will synthesize today's comments / questions and issue a report of findings to the RFP Evaluation Committee and the Roundtable

2 Online Survey

An online survey soliciting more detailed opinions on the presentations will be made available at the end of this meeting. The survey will remain open until **March 15**. The findings of this survey will also be issued to the Evaluation Committee and the Roundtable.

3 Iterative Evaluation

Based on community feedback, internal review, & financial feasibility, a tiered list of finalists will be sent to the Roundtable for discussion on **March 22**

4 Selection & Negotiation

Once a team is selected, DPD will refer to feedback from these sessions and future engagement opportunities to advance negotiations and amend the winning proposal

Early Questions:

- How many jobs generated?
- Connection to 2018 Quality of Life Plan (*see Economic & Workforce Development section*)
 - Market & strengthen NL as a business hub
 - Preserve and grow local **employment opportunities in industrial & advanced manufacturing sector**
 - Encourage business to **hire local residents & address barriers to doing so**
 - Increase the impact of existing **local wealth building programs** to help residents
 - Increase locally owned and high-quality retail & service businesses

Material Released:

- One-page summaries
- Economic impact summary
- RFP development team info

Roosevelt & Kostner Community Presentations

February 23 & 24, 2021

Economic Impact Summary

Respondent Team	Proposed Direct Permanent Job Impact	Proposed Total Development Costs	Proposed Sources of Funds
Related Midwest + 548 Development	500 new jobs	\$38.3 M	Equity, Debt, City Asst.
CNI + East Lake + MK Asset Management	320 new jobs	\$44.8 M	Equity, Debt, TIF, NMTC, City Asst.
Pritzker Realty Group + Cubs Foundation	58-108 + 8 new jobs	\$19.5 M + \$26.7 M	Equity, Debt + Philanthropy
KMA + McCaffery	807 new jobs	\$173 M	Equity, Debt, City Asst.
Matanky + North Lawndale Employment Network	Depends on biz: 45 – 600 new jobs	\$80.0 M	Equity, Debt, TIF, NOF, NMTC, City Asst.
RK5 (McLaurin, JGMA, & BOWA & partners)	TBD	\$90 M	Equity, Debt, TIF, Grants

DEVELOPER TEAM PRESENTATIONS

Roosevelt & Kostner Community Presentations

February 23 & 24, 2021

About the Facilitator – Claudette Baker



- Advisor to foundations and nonprofits delivering training and providing technical assistance to organizations and their leaders through a racial equity lens
- Skilled facilitator in group process and has experience working with the public sector and a range of organizations including grassroots and community-based organizations, and faith-based institutions
- Career has spanned the for-profit, government and nonprofit sectors for more than 40 years

Community Agreements



1. Please **mute** yourself during the presentation(s) and when you are not speaking
2. Please state your name when speaking
3. Please use the **Zoom Q&A function** for any questions outside the designated Q&A period with developers
4. When responding verbally, **raise your hand**; respect the stack and then step up and step back
5. All questions and ideas are valid
6. Respond with respect

548 DEVELOPMENT & RELATED MIDWEST

Roosevelt & Kostner Community Presentations

February 23 & 24, 2021

548 Development & Related Midwest

Proposed Uses:

- 153,400 SF industrial building on north property
- 174,152 SF industrial building on the south property
 - 10,000 SF within south property will be donated to create the *Lawndale Innovation Center*

Development Team:

Related Midwest
548 Development (MBE)

Design Team:

Ware Malcomb
TNS Studio (MWBE)

Construction Team:

Related Midwest in-house
Milhouse (MBE)
Engage Civil (MBE)



Roosevelt & Kostner Community Presentations

February 23 & 24, 2021

548
DEVELOPMENT

RELATED



LAWNDALE UNITED

(MK ASSET MANAGEMENT, CNI GROUP, & EAST LAKE MANAGEMENT)

Lawndale United

Proposed Uses:

- One 155,000 SF industrial building
- Two additional 88,000 SF industrial buildings
- The two main user groups who will be attracted to this location are e-commerce/fulfillment/last mile distribution and food/beverage distribution and production
 - Reduced rent will be applied on 10% of the total industrial space to attract small businesses.
 - 4,000 square feet will be set aside for an employment training program and an entrepreneurs' support center.



PROPOSED FACILITIES

4300 W. ROOSEVELT ROAD, CHICAGO, IL 60624

©CORNERSTONE ARCHITECTS LTD. 2020

DECEMBER 24, 2020 #20304



Development Team:

CNI Group
East Lake Management (MBE)
MK Asset Management

Design Team:

Cornerstone Architects
Roderick/Ardmore (MBE)

Construction Team:

Burling Builders (MBE)
Spaceco Inc

Community Partners:

Black Men United
CEDA
Trinal
Westside American Job Center

Roosevelt & Kostner Community Presentations

February 23 & 24, 2021



PROPOSED FACILITIES

4300 W. ROOSEVELT ROAD, CHICAGO, IL 60624

©CORNERSTONE ARCHITECTS LTD. 2020

DECEMBER 24, 2020 #20304





PROPOSED FACILITIES

4300 W.ROOSEVELT ROAD, CHICAGO, IL 60624

©CORNERSTONE ARCHITECTS LTD. 2020

DECEMBER 24, 2020 #20304





PROPOSED FACILITIES

4300 W.ROOSEVELT ROAD, CHICAGO, IL 60624

DECEMBER 24, 2020 #20304



PROPOSED FACILITIES

4300 W.ROOSEVELT ROAD, CHICAGO, IL 60624

DECEMBER 24, 2020 #20304

Preferred Site Plan / Massing

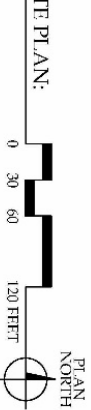
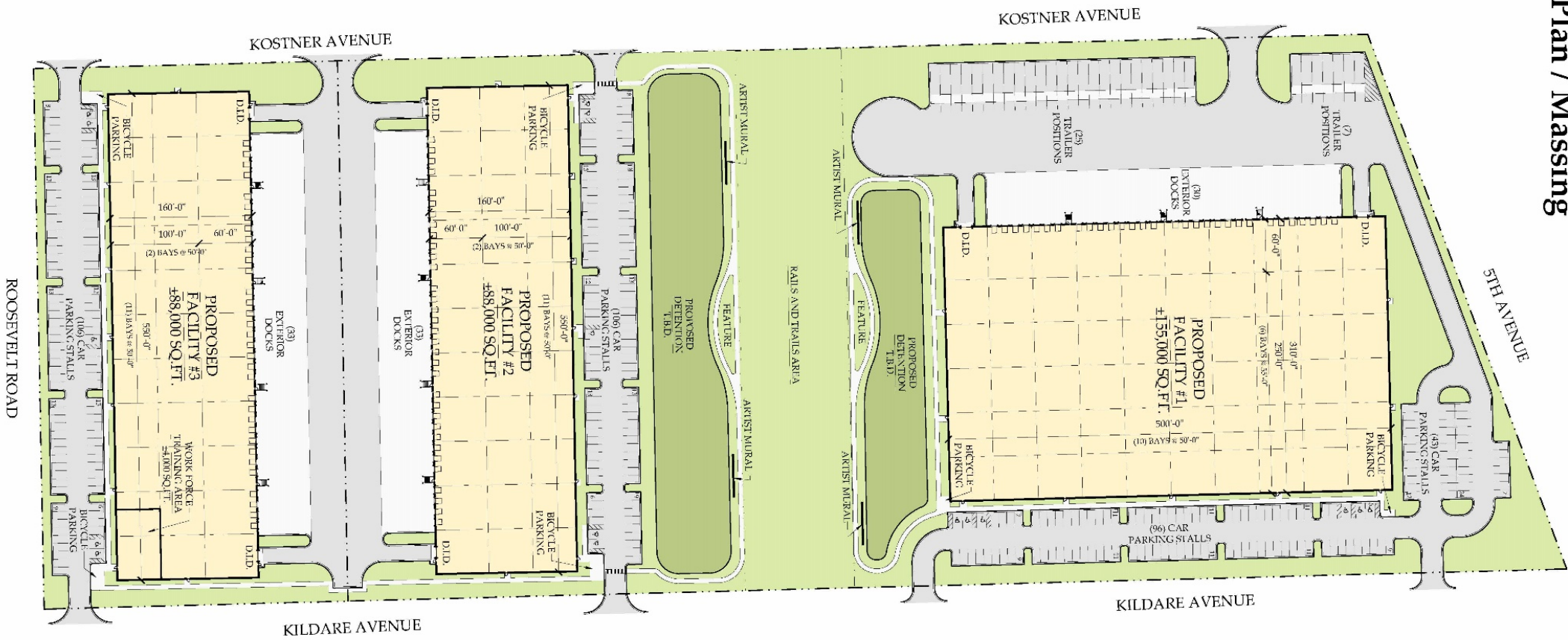

PROPOSED FACILITIES

OPTION #1

DECEMBER 24, 2020 #20304

CUBS CHARITIES & PRITZKER REALTY GROUP

Roosevelt & Kostner Community Presentations

February 23 & 24, 2021

Cubs Charities & Pritzker Realty Group

Proposed Uses:

- 194,540 SF industrial warehouse or cold storage facility on north property
- 86,080 SF multi-purpose facility, outdoor fields, and community space on south property

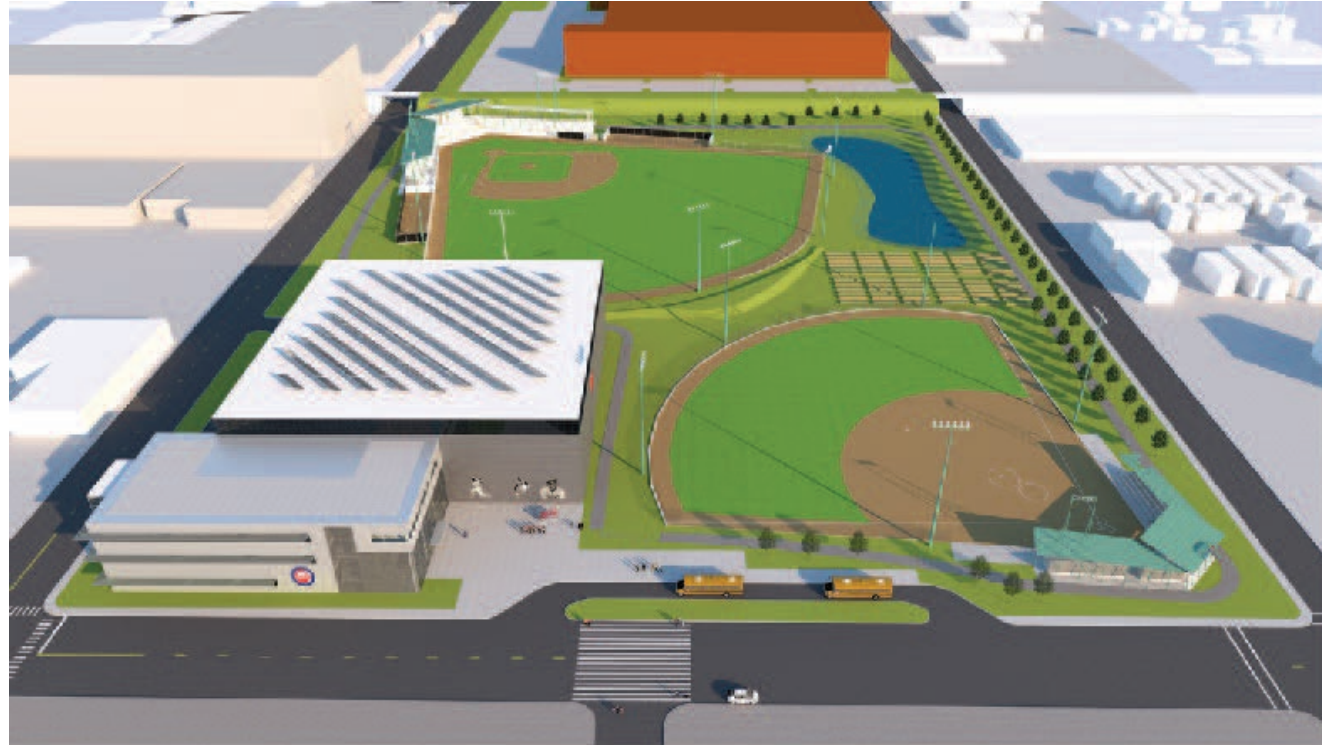

WEISS
Architects, P.L.L.C.
nia architects
5400 N. ROOSEVELT



CUBS URBAN YOUTH ACADEMY
4350 WEST ROOSEVELT ROAD
CHICAGO, ILLINOIS



December 24, 2020
010000 0000 0000 0000

Development Team:

Cubs Charities
Pritzker Realty Group
Prim Lawrence Group
(MWBE)

Design Team:

Nia Architects (MBE)
WEISS Architects
Cornerstone Architects

Construction Team:

SpaceCo, Inc
Carlson Environmental
ABCO Electrical & Design

Roosevelt & Kostner Community Presentations

February 23 & 24, 2021



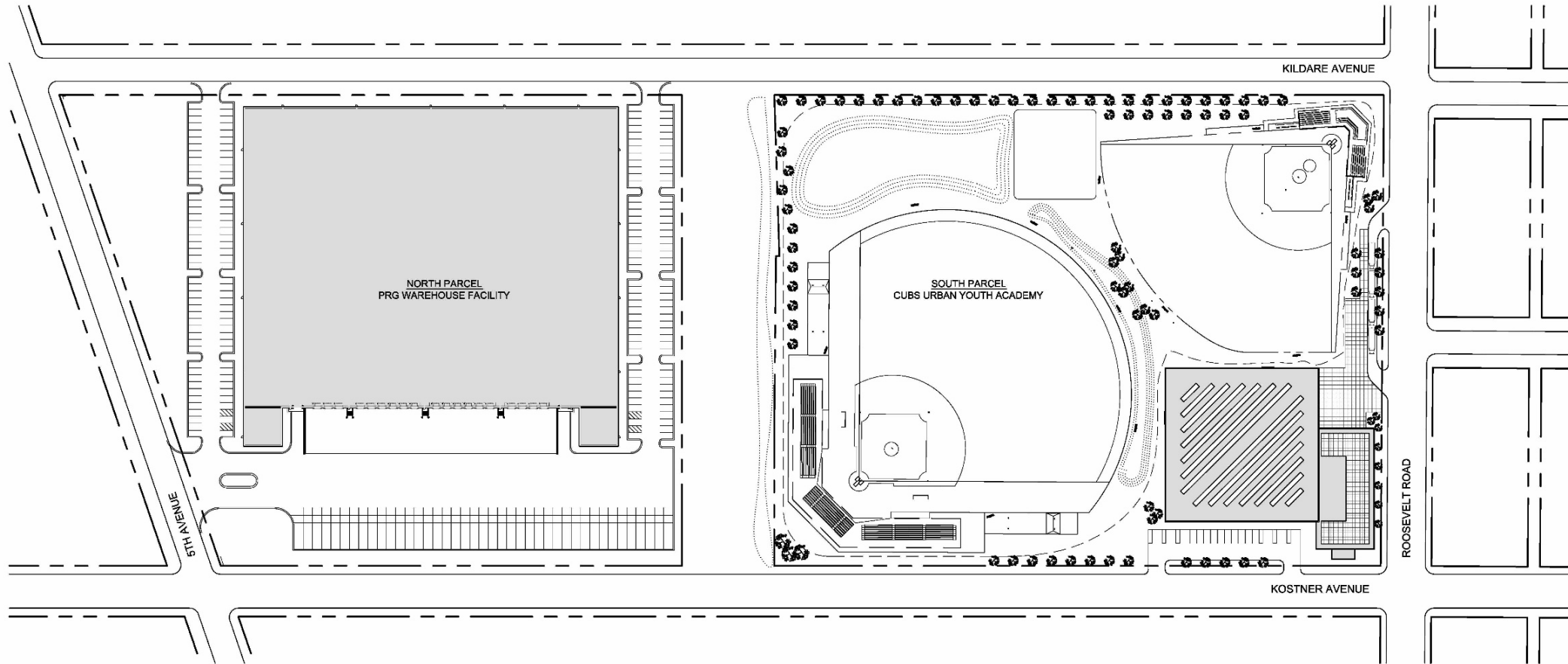

WEISS

Architecture • Planning • Design

nia architects

Architect of Record



CUBS URBAN YOUTH ACADEMY

4300 WEST ROOSEVELT ROAD
CHICAGO, ILLINOIS



OVERALL SITE PLAN



80 160

December 24, 2020
© 2020 Weiss Architects, LLC



WEISS

Architects • Planners • Design

nia architects

1400 N. LAKE STREET



CUBS URBAN YOUTH ACADEMY

4300 WEST ROCKEFELLER ROAD
CHICAGO, ILLINOIS



December 24, 2020
9:00 AM - 10:00 AM



WEISS

Architects • Planners • Design
nia architects
 1400 WEST ROOSEVELT ROAD



CUBS URBAN YOUTH ACADEMY

4300 WEST ROOSEVELT ROAD
 CHICAGO, ILLINOIS



December 24, 2020
 9:00 AM PM 10:00 AM



WEISS

Architects • Planners • Design
nia architects
 1400 WEST ROOSEVELT ROAD



CUBS URBAN YOUTH ACADEMY

1400 WEST ROOSEVELT ROAD
 CHICAGO, ILLINOIS



December 24, 2020
 9:00 AM PM EST

NEXT STEPS

Roosevelt & Kostner Community Presentations

February 23 & 24, 2021

Online Survey



Austin RFP Survey - Day 1 (Jan 19, 2021)

Please provide your feedback on the proposals presented at the January 19th Austin ISW Roundtable (Holsten + New Moms, 548 Development, Imagine + Evergreen). Please see the Day 2 survey for material presented on January 20th.

* Required

1

What is your name? *

Enter your answer

2

What is your email address? *

Enter your answer

3

Are you an Austin resident? *

Enter your answer



☆ ☆ ☆ ☆ ☆

18

IMAGINE GROUP + EVERGREEN
REDEVELOPMENT: What excites you
most about this proposal? *

Enter your answer

19

IMAGINE GROUP + EVERGREEN
REDEVELOPMENT: What concerns
you most about this proposal? *

Enter your answer

Roosevelt & Kostner Community Presentations

February 23 & 24, 2021

Next Steps

- 1** DPD will synthesize today's comments & online survey responses, and incorporate into review process
- 2** Based on community feedback, internal review, & financial feasibility, a tiered list of results will be sent to the Roundtable for **feedback in March**
- 3** Once final materials have been reviewed, a winning team will be selected and announced
- 4** Continued negotiation / proposal refinement will be advanced with additional opportunities for engagement