



North Milwaukee Ave.

from Logan Square to Belmont

Logan Square Centennial Redesign

February 2025 – Construction Start Update

CARLOS ROSA
35TH WARD ALDERMAN

 **CDOT**
Chicago Department
of Transportation

Agenda

- Welcome and Introduction, Alderman Carlos Ramirez-Rosa
- Project Design Presentation, Conan Chan, Chicago Department of Transportation
- Project Impacts Discussion, Keith Moroni, Resident Engineer and Dan Melnyk, Capitol Cement Company
- Small Business Support, Nilda Esparza, Logan Square Chamber of Commerce
- Question & Answer

Milwaukee Avenue Roadway Reconstruction and Streetscape

Agenda - February 2025 Construction Update

- **Project Overview**
- **Project Design Recap**
 - Milwaukee Avenue
 - La Placita
 - Logan Square



Current Project Area

Milwaukee Avenue Roadway Reconstruction and Streetscape

Current Milwaukee Avenue Reconstruction Project, includes improvements from south of Belmont to Logan Boulevard / Logan Square.

Current project is “Section 5” of overall corridor.

Four project sections previously completed:

- Jefferson Park CTA Terminal to Montrose
- Montrose to Irving Park
- Irving Park to Addison
- Addison to Belmont

Future planned sections will continue southeast towards downtown.

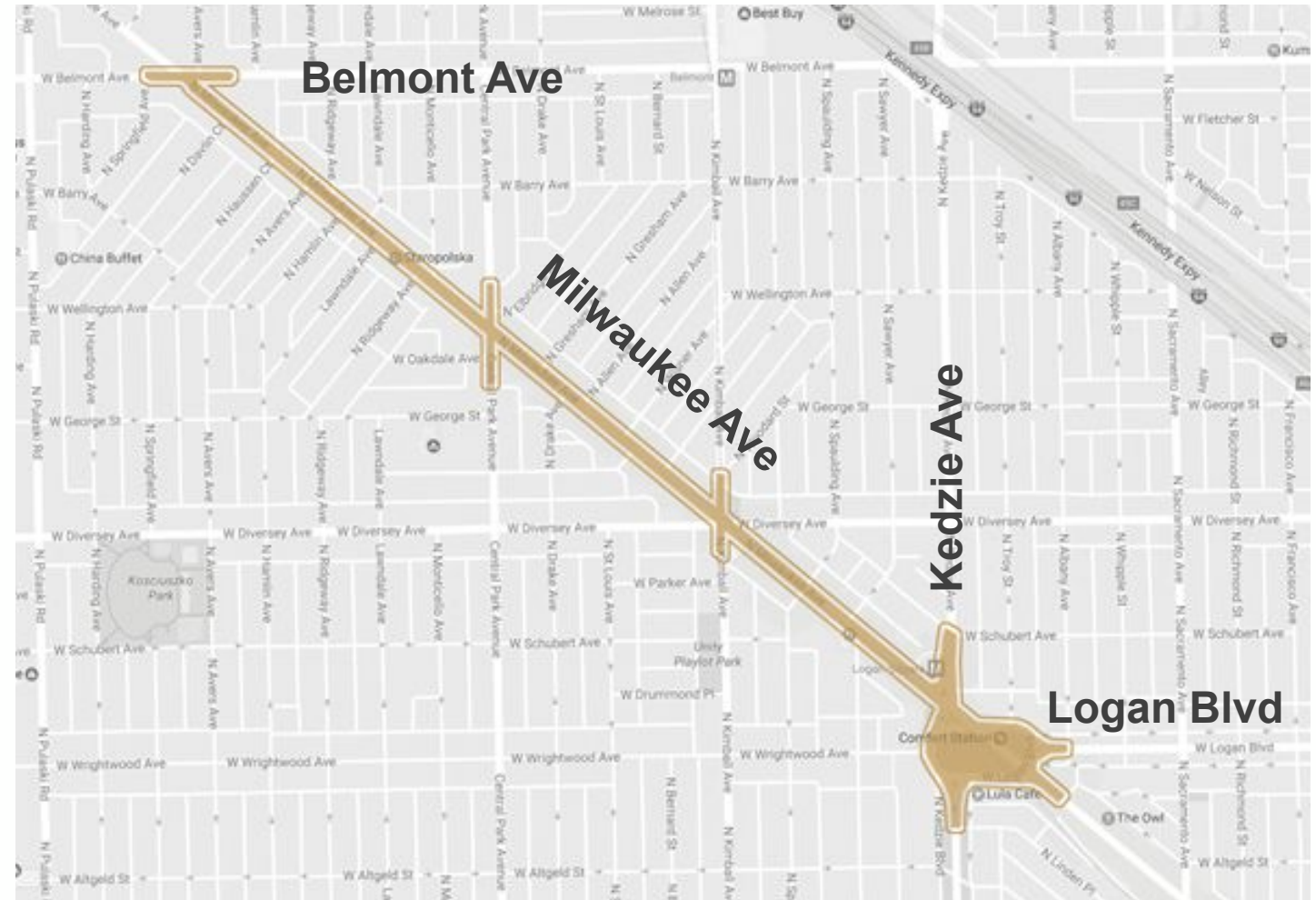

Design Recap

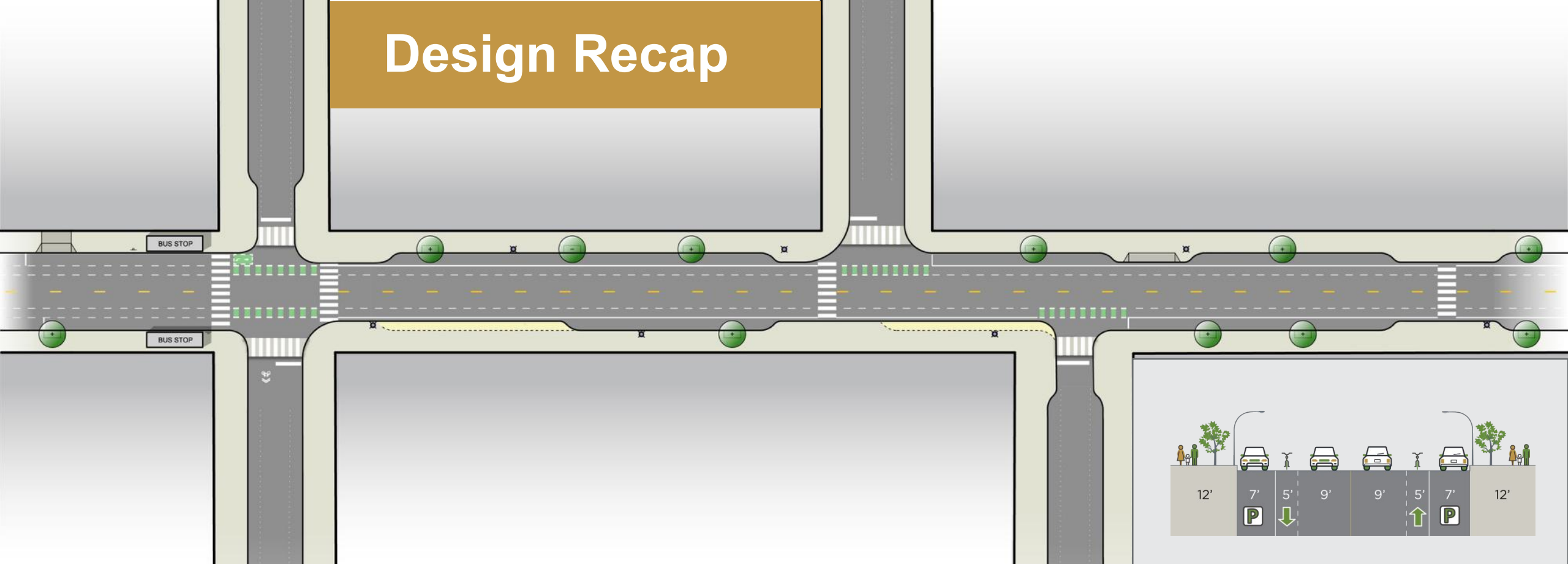

Milwaukee Belmont to Logan Roadway Reconstruction

- Rebuild roadway, all sidewalks, curb and gutter
- Modernize all traffic signals within project area, add new traffic signal at Haussen / Hamlin
- Accessible Pedestrian Signals at all signalized intersections to improve accessibility
- New advisory (dashed) bike lanes, curb extensions, raised crosswalks on side streets
- New longer curb extensions at restaurants for additional outdoor seating
- All new street lighting
- New parkway trees

Design Features

- 0.95 miles of new advisory (dashed) bike lanes
- 19 raised crosswalks on select side streets
- 70 curb / sidewalk extensions
 - 27 on Milwaukee Ave
 - 6 on Kedzie Ave
 - 37 on side streets
- 85 new trees planted

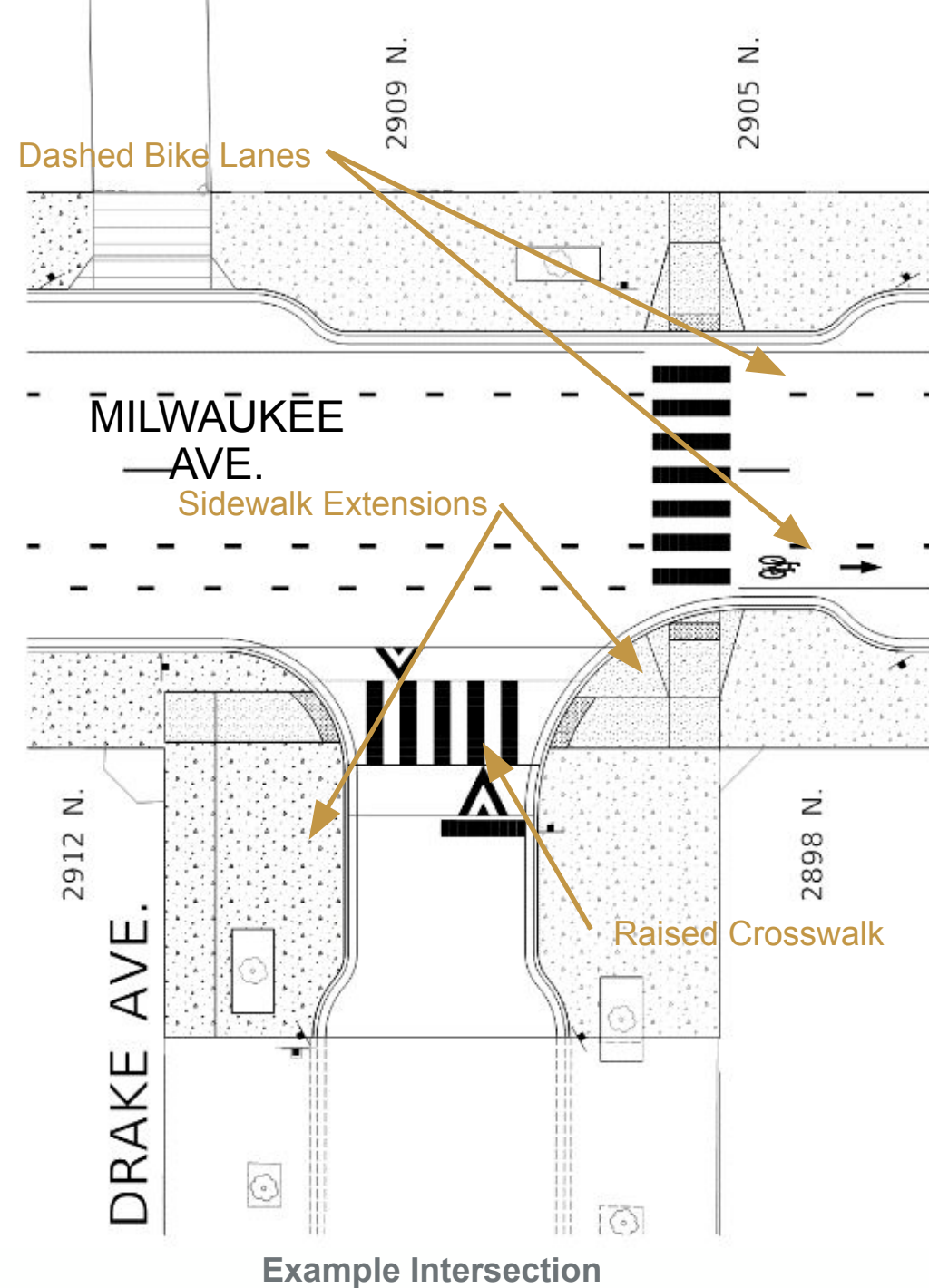

Raised Crosswalks

Raised Crosswalk Detail



Example Clifton Ave. & School St.

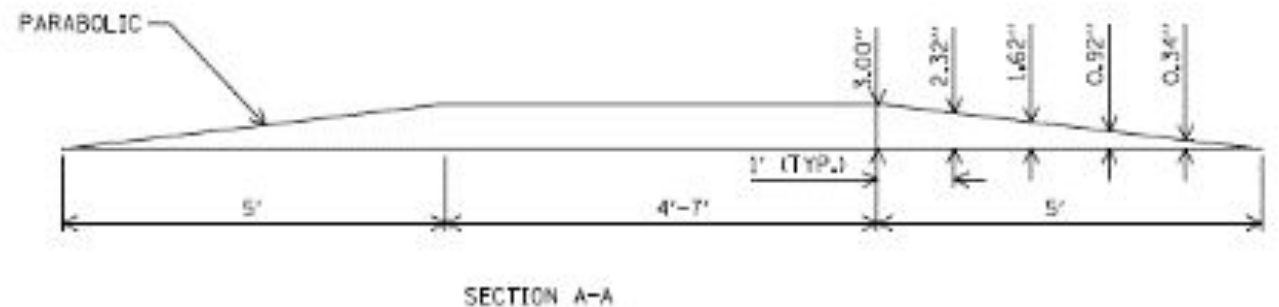
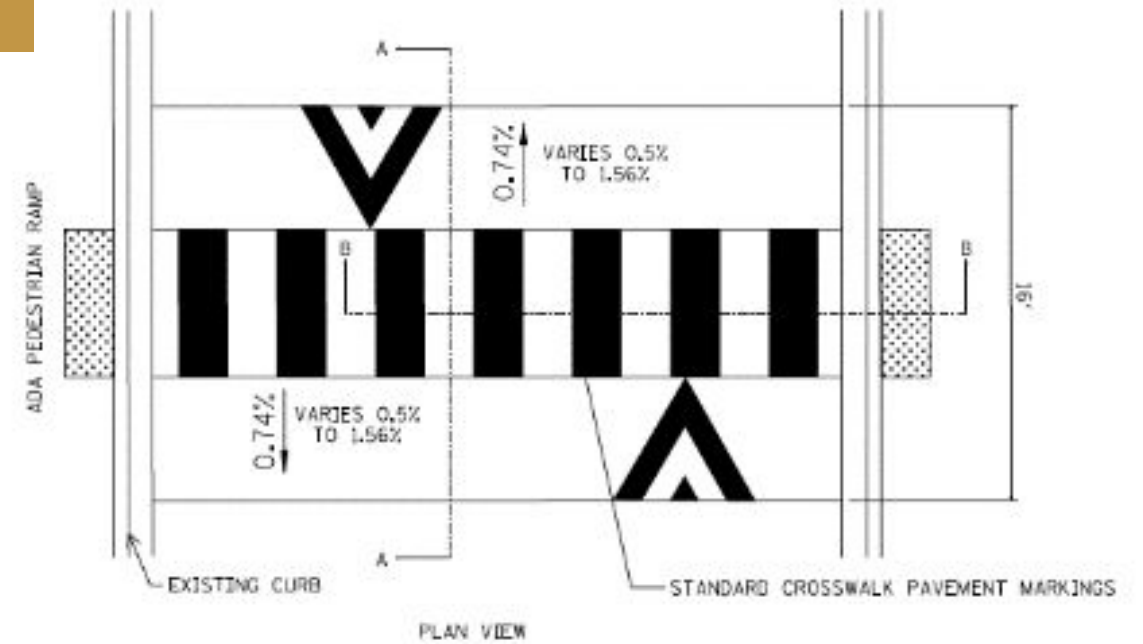

Curb Extensions

Improved visibility of pedestrians waiting to cross street

Shorter crosswalks reduces time pedestrians are exposed to traffic

Reduced turning speeds for drivers

Increased space for pedestrians and sidewalk cafes



Example

Additional Crosswalks

Diversey / Kimball / Milwaukee improvements will include two new sets marked crosswalks and pedestrian signals to improve circulation for pedestrians.

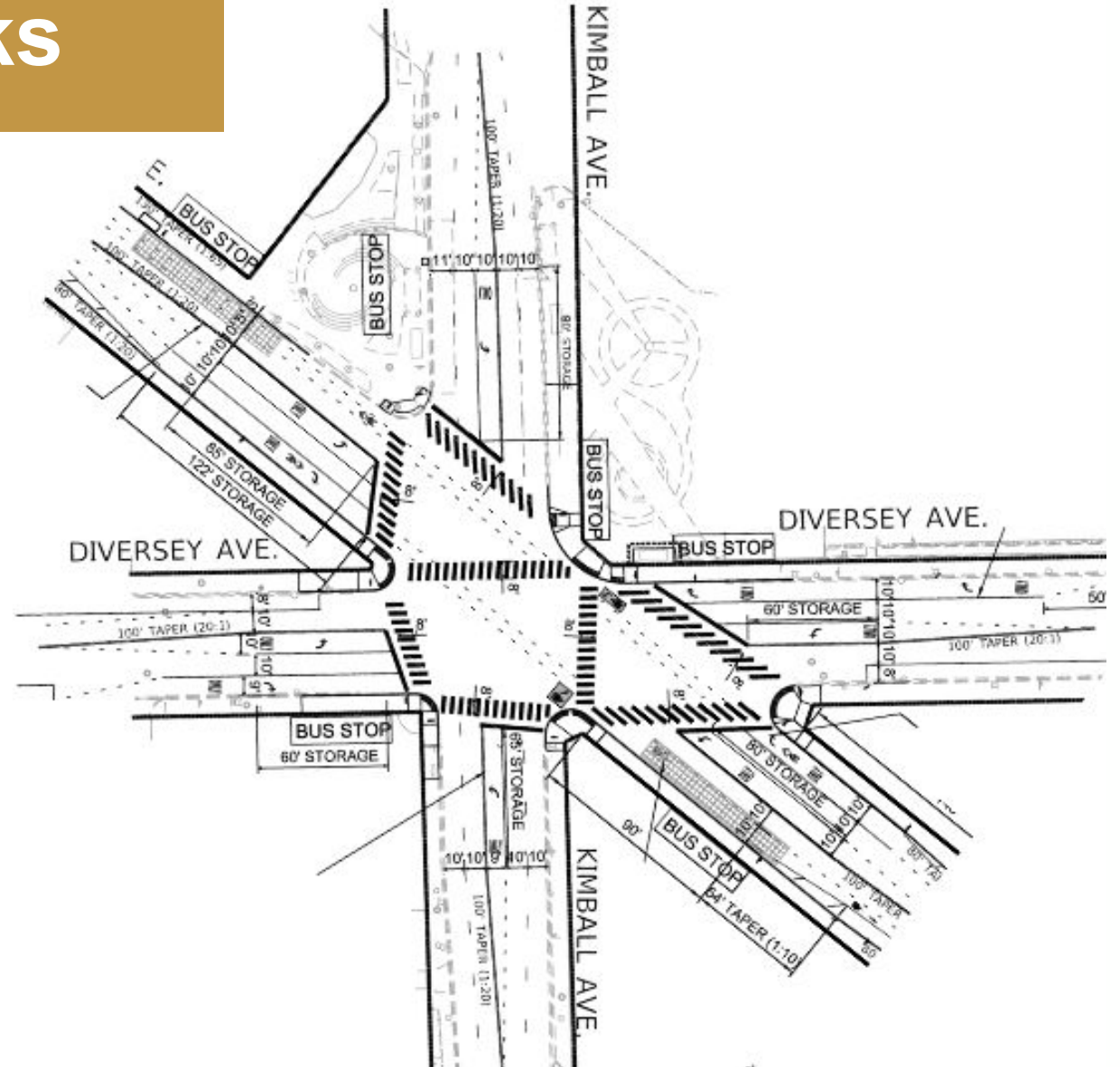

La Placita Final Design

- The final design is a result of stakeholder input from various community organizations combined with arrangement of the site by the CDOT team of professional landscape architects and engineers.



Plaza Comparison

- Increased pedestrian space within new La Placita design
- Unified public space across bus lane
- CTA station becomes center of La Placita

New Pedestrian Space Overlay in Orange
Current Pedestrian Space Overlay in Purple

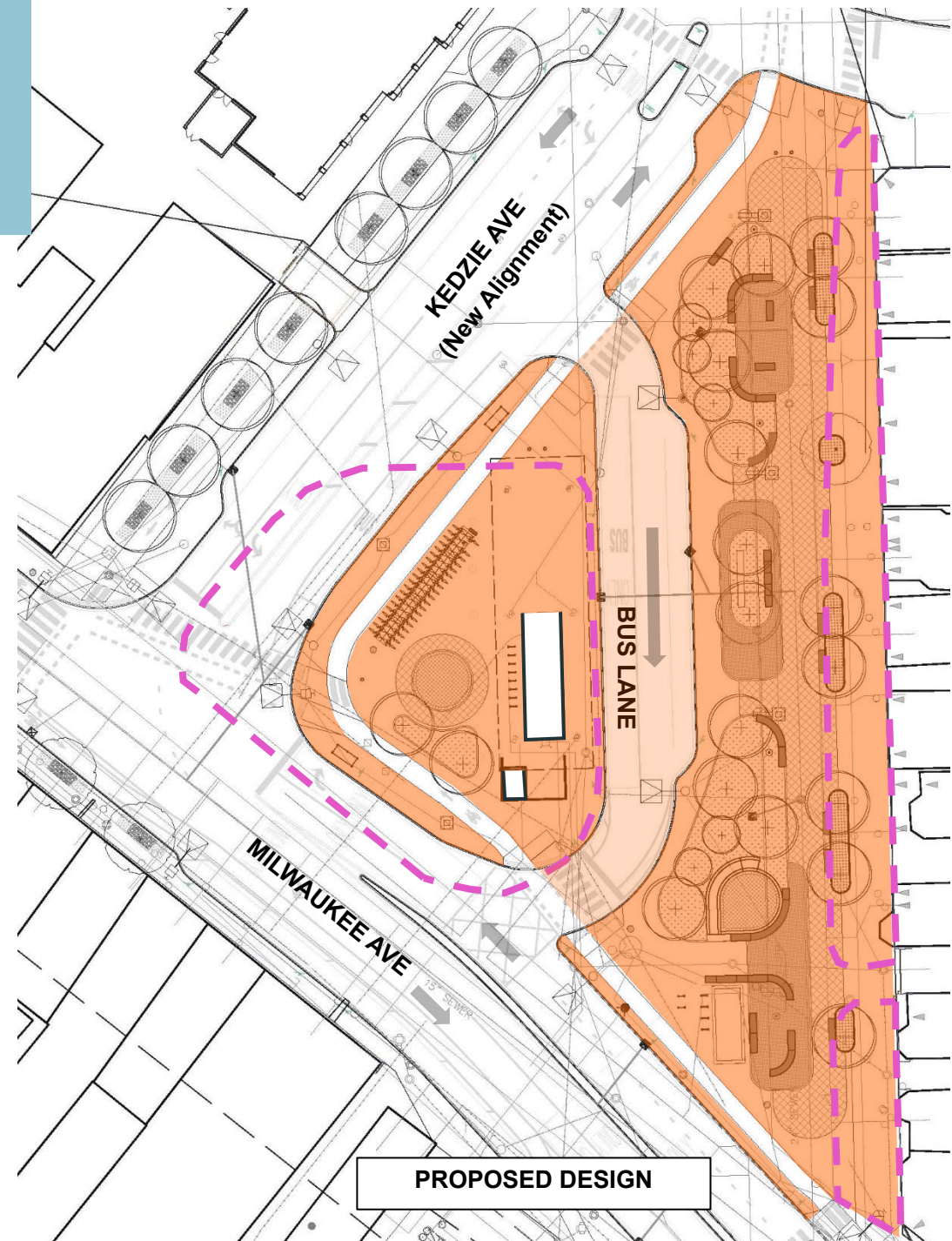

PHASE 1
CDOT Construction of La Placita



Logan Square Reconfiguration

Improvements & Impacts

- Increased public space
- Improves pedestrian access
- Protected off-street bicycle paths around Square
- Allows flexible use of public streets
- Improves traffic safety



Surface Impacts

Roadway

- Current roadway to remain
- Roadway area gained

Non-Roadway

Plazas, sidewalks, and/or greenspace

- Current non-roadway to remain
- Non-roadway area gained

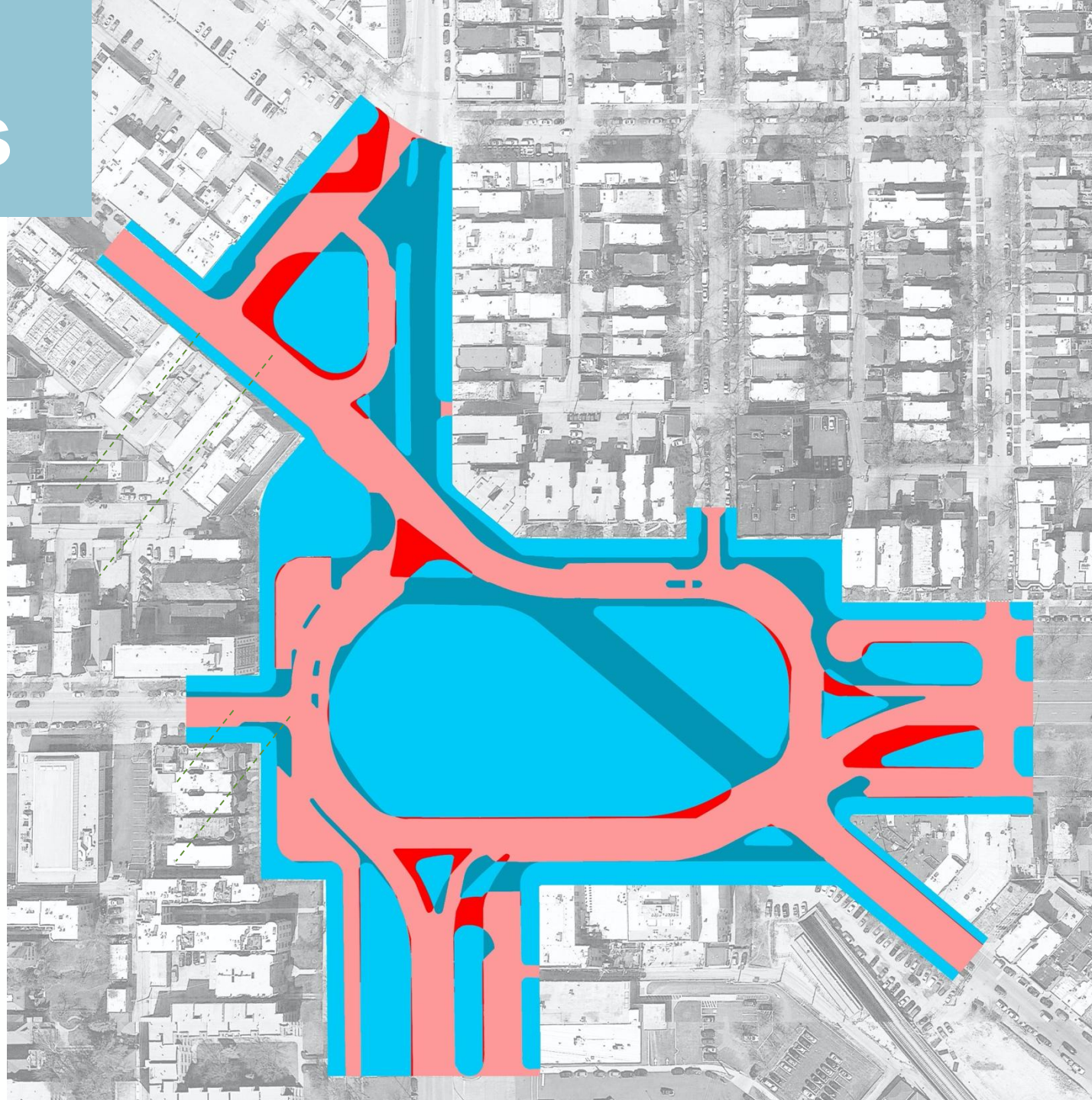

Circulation

- Movement to monument base
ADA accessible
- Bike use on periphery of Logan
Square to designated bike
routes

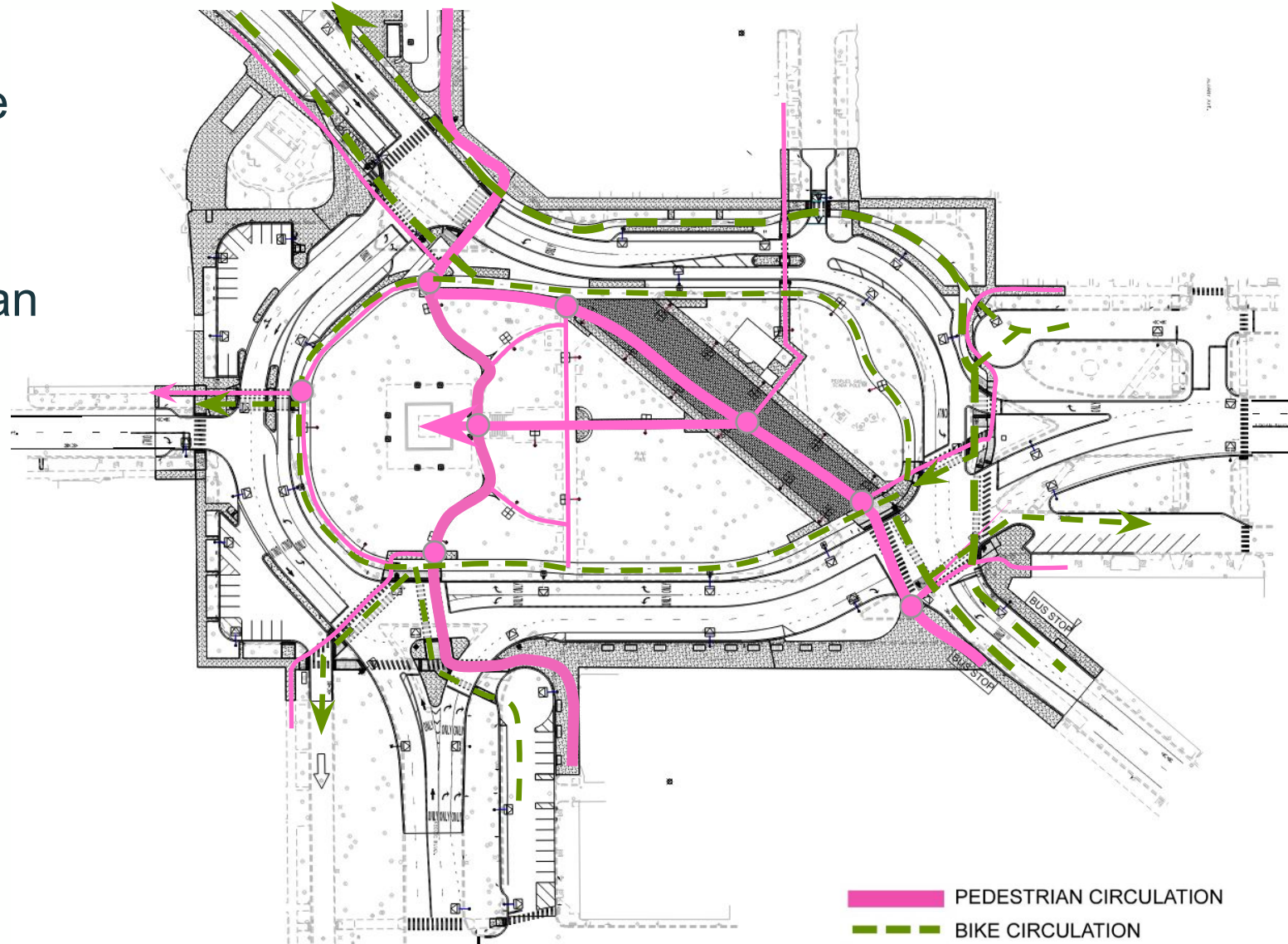

Early 2025 Construction Focuses

- The south side of Milwaukee Avenue, from Diversey to Kedzie.
- Inner lanes of the Logan Square Circle.
- Excavation of Milwaukee Avenue through Logan Square.



Milwaukee Avenue Roadway Work

- Commencing on the south side of Milwaukee Avenue from Diversey to Kedzie
- Work consists of:
 - Temporary fence installation,
 - Curb and gutter replacement,
 - Conduit installation,
 - Sidewalk replacement,
 - and Street Light Installation.



Milwaukee Avenue Roadway Work

- Access to businesses and residences is maintained throughout
- While concrete cures, planks are placed for access.
- The new concrete is walkable and the wooden planks are typically removed the next working day.



Logan Square Redesign Work

- As work commences, Milwaukee Avenue through the square will be closed.
- Traffic will be shifted to the outer lanes, while work is completed on the inner ring.
- Construction of the new Logan Square Plaza will begin.
- Electrical and irrigation work will begin within Logan Square Park.

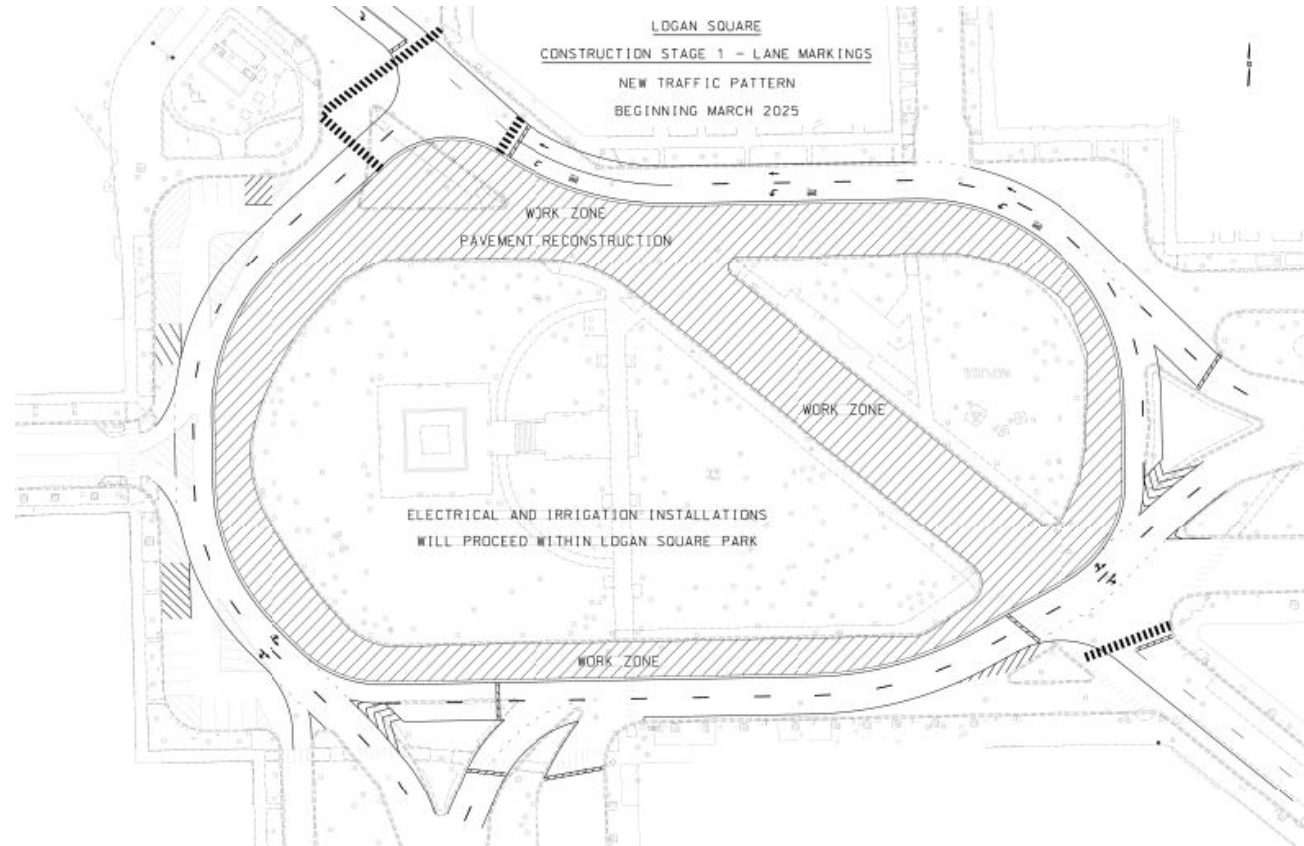

Small Business Support

- Updates shared through Logan Square Chamber of Commerce Newsletter
- Business Support Committee
- Local Business promotion through the Logan Square Chamber of Commerce

Question & Answer

Please raise your hand if you have a question

Close

**Contact the 35th Ward
Office:**

2934 N Milwaukee Ave, Unit C

(773) 985-3510

ward35@cityofchicago.org

Keith Moroni

Resident Engineer

keith.moroni@aecom.com