

CDOT PEOPLE SPOT

DESIGN AND ASSEMBLY MANUAL

VERSION 1 - 11-01-2018





This is the design and assembly manual for a standard People Spot, a temporary platform that turns an existing parking spot into an outdoor space designed to be enjoyed by all. This People Spot is a prototype of a standard design available for public use through the Chicago Department of Transportation’s Make Way For People program.

CONTENTS

- 1. PARKLET EXAMPLES - NATIONAL - 3**
- 2. PEOPLE SPOT EXAMPLES - CHICAGO - 4**
- 3. STANDARD PEOPLE SPOT DESIGN - 6**
- 4. STANDARD PEOPLE SPOT ASSEMBLY - 11**
- 5. PEOPLE SPOT MAINTENANCE - 16**

PARKLET EXAMPLES

SOURCED FROM ACROSS THE UNITED STATES

A People Spot is a parklet, a small extension of the sidewalk onto parking spots that provides public space, seating and greenery to the existing streetscape. Parklets throughout the United States have similar dimensions and are typically designed to protect the new public space from passing traffic. People Spots are an extension of the sidewalk and are for public use.



Luna Rienne Parklet, San Francisco, 2014



Wine:30 Parklet, Portland, 2016



parKIT, Washington D.C., 2015



40th Street Parklet, Oakland, 2013



Ocean Ave. Parklet, San Francisco, 2014



SMU Parklet, Dallas, 2012

PEOPLE SPOT EXAMPLES

PREVIOUS CHICAGO EXAMPLES

People Spots of varying designs have already been constructed throughout Chicago. The new standard People Spot is designed to be easier to assemble, reuse and expand while still keeping the standard amenities of public seating and greenery.



The Wave People Spot, 2014



47th Street People Spot, 2014



Logan Square Parklet, 2017



Lakeview People Spot, 2013



Color Guard People Spot, 2015



Andersonville People Spot, 2013

HOW TO BUILD A PEOPLE SPOT

There are a few steps to go through to get a People Spot on a street. Below is an outline of the process.

I. SELECT A SITE

Work with CDOT to decide on a location for the People Spot. Peoples spots are designed to fit on a typical Chicago curb. A site plan showing the location of the proposed People Spot will need to be submitted for approval, along with the following information:

- Adjacent building Address
- Accurate dimensions
- Surface obstructions within 10 feet of the People Spot, including:
 - Fire Hydrants
 - Light Poles
 - Pay Meter Boxes
 - Trees
 - Planters
- Spot elevations along the length of the proposed people spot
- Curb Elevations
- Street Elevations
- Proposed number of tables and chairs

2. CONSULT DESIGN AND ASSEMBLY MANUAL

Consult this guide to help decide on placement, size, and module for your People Spot.

3. USE STANDARD PEOPLE SPOT OR CUSTOM DESIGN

A standard People Spot design is available for public use and can be downloaded through the Make Way For People website at makewayforpeople.org. This manual provides assembly instructions for the standard People Spot design.

A professionally certified set of drawings showing people spot layout, tables and chairs, construction details, survey and structural calculations shall be provided after preliminary approval. Design professional must be certified or licensed in Illinois. All People Spots must meet City of Chicago Department of Buildings load-bearing requirements.



STANDARD PEOPLE SPOT DESIGN

The standard People Spot is designed with modular components, allowing users to adjust the size of the platforms, planters and benches for the chosen site. This section outlines the parts and components that make up a People Spot.

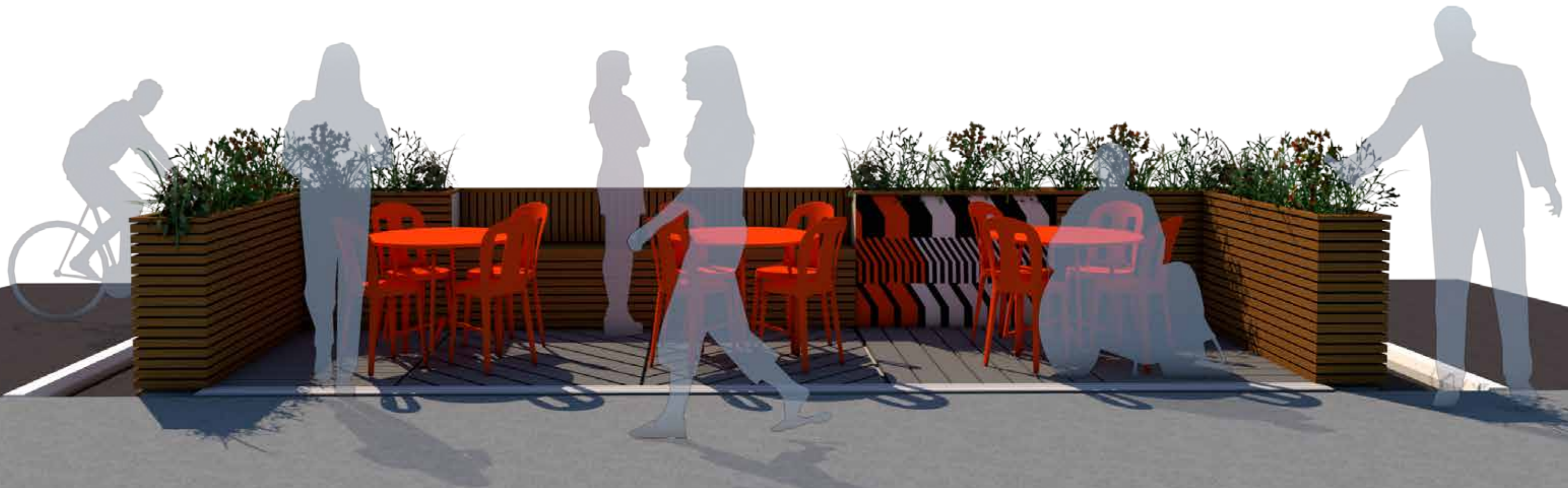

PEOPLE SPOT MODULES

The standard People Spot is designed in modules that can be rearranged and expanded to fit sites anywhere from 20'-80' in length. Each module is 4' wide and 6' long and is designed to fit a planter or bench on the side facing the street to protect users from traffic.

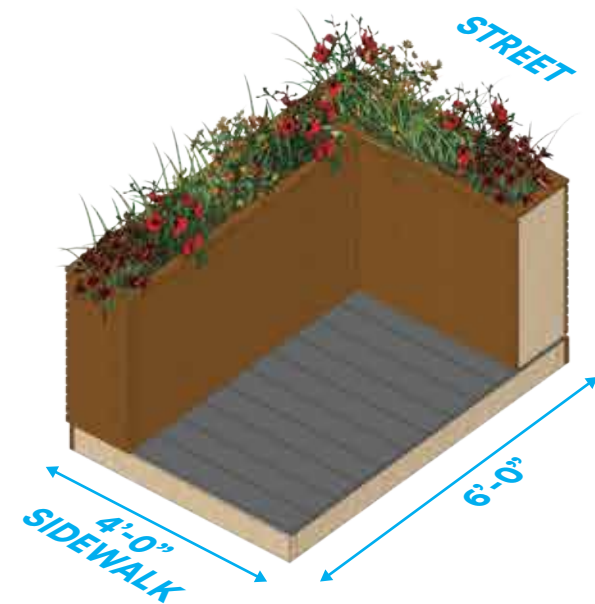

CORNER PLANTERS
Planters on the ends of the People Spot clad with cedar planks. 5'x1' planter on the parking lane side, 4'x1' planter on the traffic lane side.

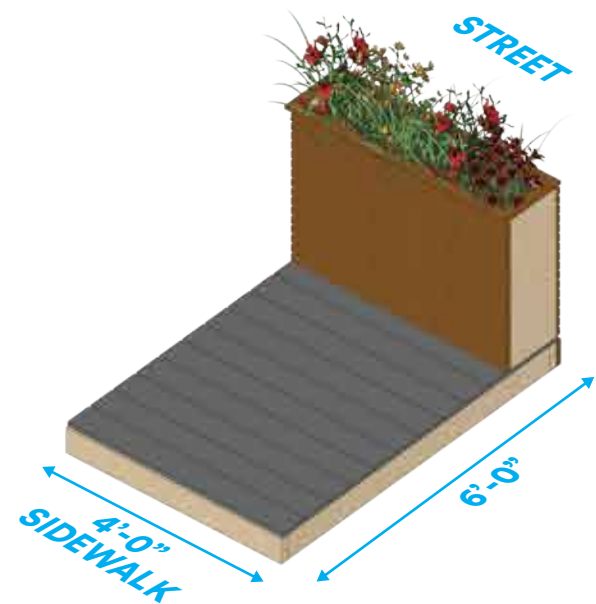

PLANTERS
Planters on the traffic lane of the People Spot clad with cedar planks.

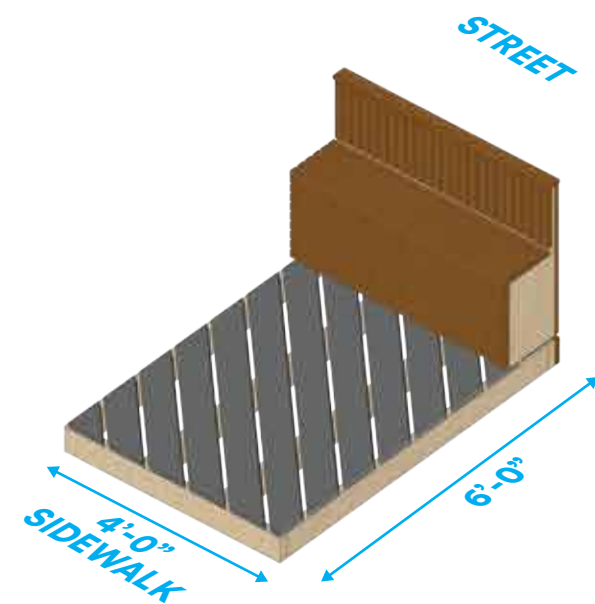

BENCHES
18" seat height with a 12" deep bench. Maximum of 2 benches adjacent to each other.

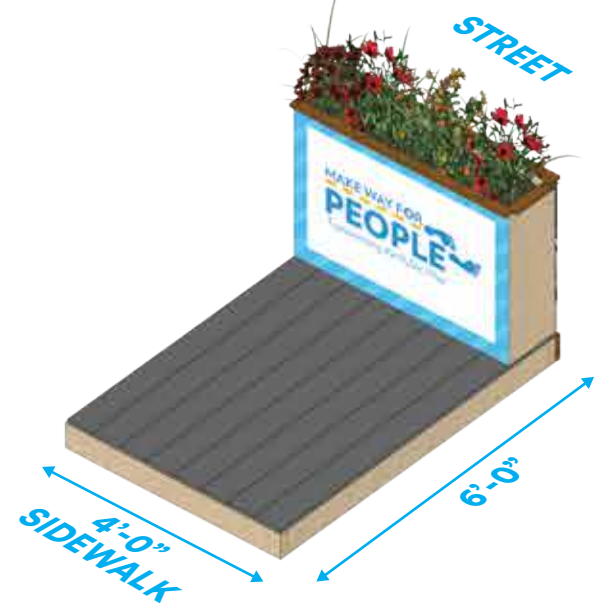

ART PANEL PLANTERS
Planter module clad with panels either printed with art or carved/milled into an artistic pattern.

The People Spot platform should be flush with the sidewalk and curb. A minimum dimension along the platform at its transition with the sidewalk shall provide wheelchair access, as outlined below:

- 40' Deck – 8 feet of ADA access
- 60' Deck – 10 feet of ADA access
- 80' Deck – 12 feet of ADA access

PEOPLE SPOT MODULES

ARRANGEMENT DIAGRAMS

The modules of the People Spot can be combined into different designs, from 20 feet up to 80 feet in length. Here are examples of some of the many possible combinations.

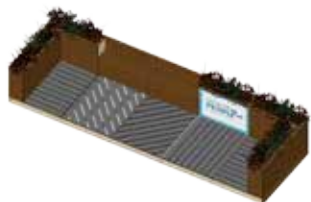

20' - 5 Modules

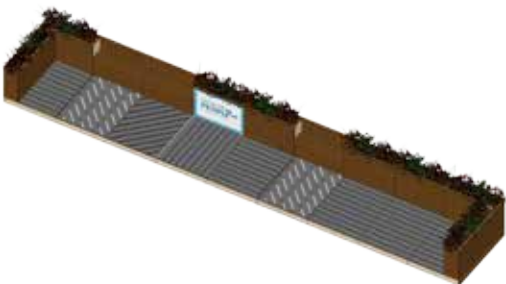

40' - 10 Modules

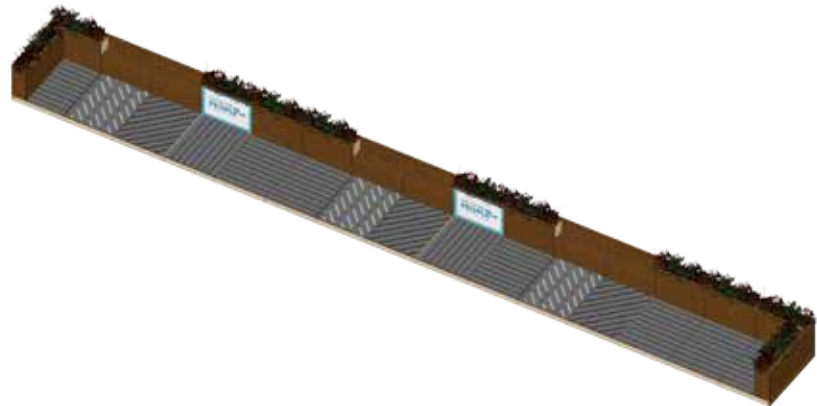

60' - 15 Modules

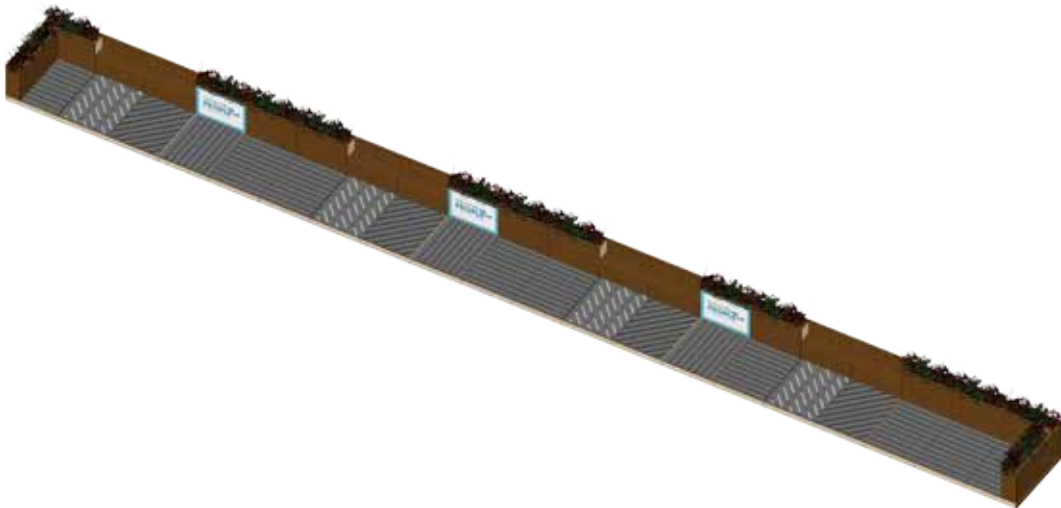

80' - 20 Modules

PEOPLE SPOT DESIGN

EXPLODED CONSTRUCTION DIAGRAM

PLANTS
Minimum 12" soil fill w/ plant liner, see CDOT approved plant list for recommended species.

PLANTERS
Plywood planters clad in cedar planking, bolted to deck surface.

BENCHES
Plywood benches clad in cedar planking, bolted to deck surface. 1'-0" seat depth.

ART PANEL
Panel clad with customized artwork, 46" wide x 31" tall x 1/8" thick. Bolted to plywood planter.

PLATFORM DECKING
Composite or pressure-treated wood decking, fastened with clips or 2" deck screws.

PLATFORM DECK FRAMING
Deck framing in 4' x 6' sections, joists adjusted to decking pattern. Additional blocking may be needed for uneven surfaces.

TRANSITION STRIP
48" (minimum) x 6" stainless steel or aluminum transition strip for ADA platform access, to be flush with curb.

STEEL L-ANGLE
4" x 4" x 1/2" L-Angle, bolted to pavement every 48" on center.

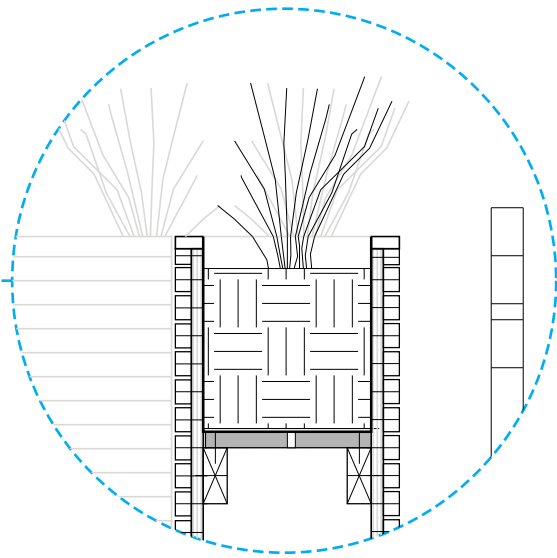
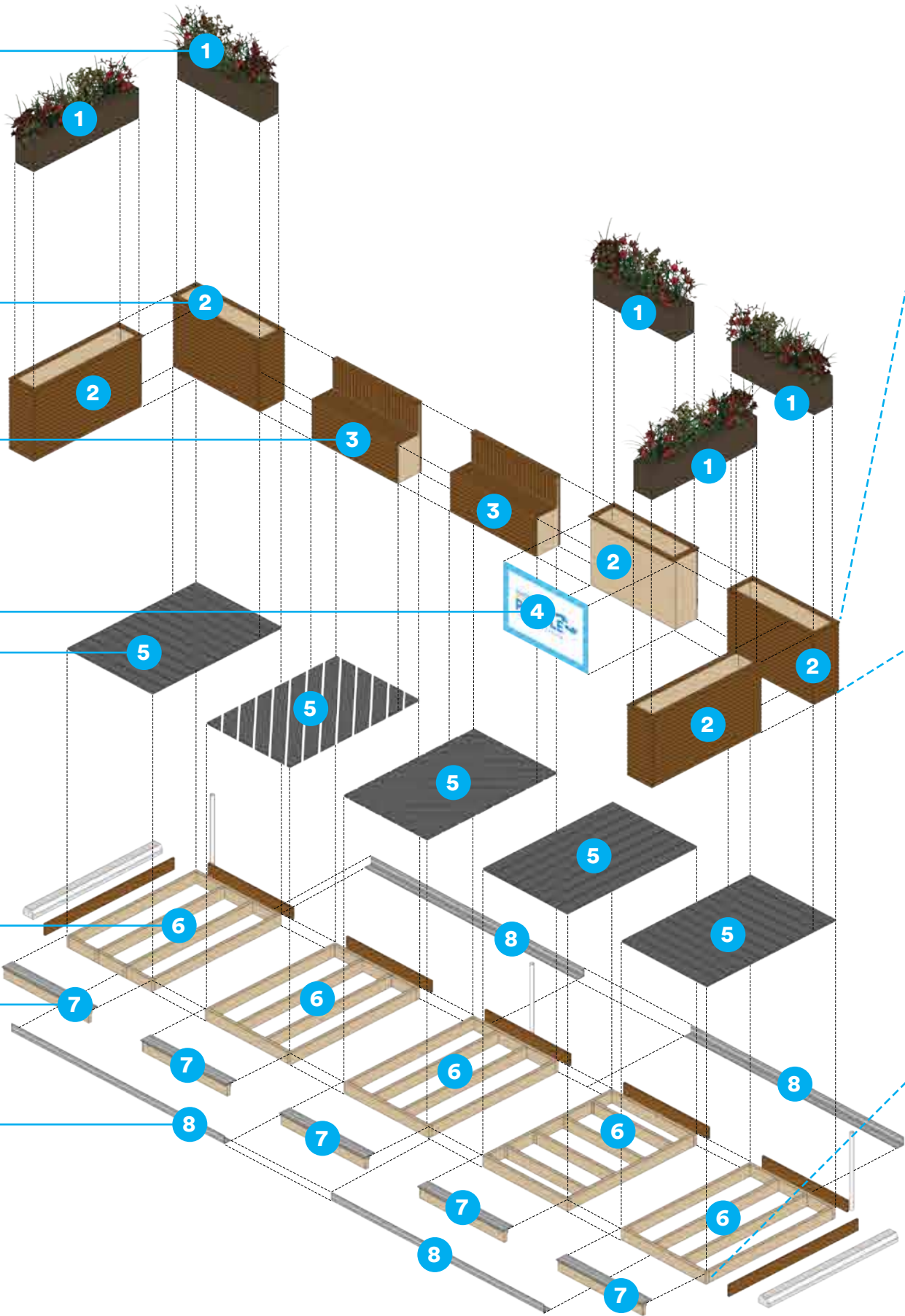

PLANTER SECTION

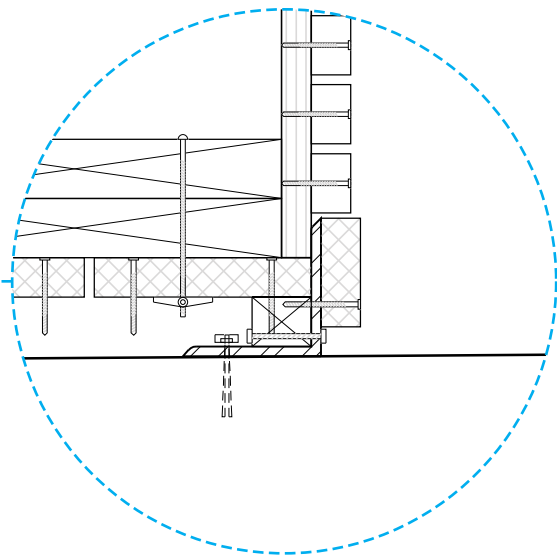

DECK EDGE DETAIL

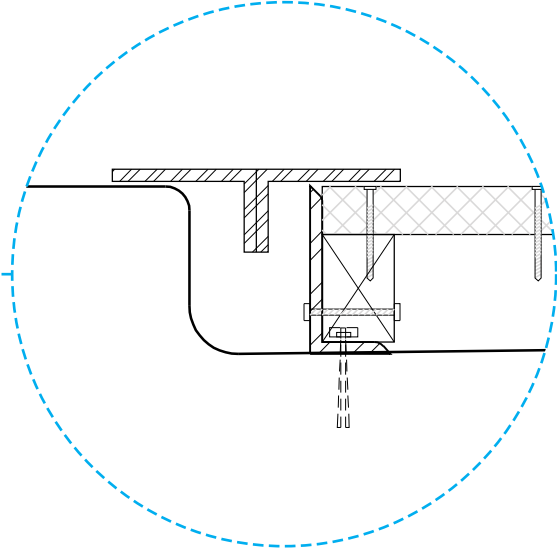

CURB DETAIL

*See technical drawings for details

CLADDING OPTIONS

PLANTER CLADDING ELEVATIONS

The standard People Spot can be clad with the shown cedar planks, different types and sizes of wood, and other materials designed to suit the location and neighborhood.



2” Cedar Planks
* 1” max spacing between
planks, typical



4” Cedar Planks

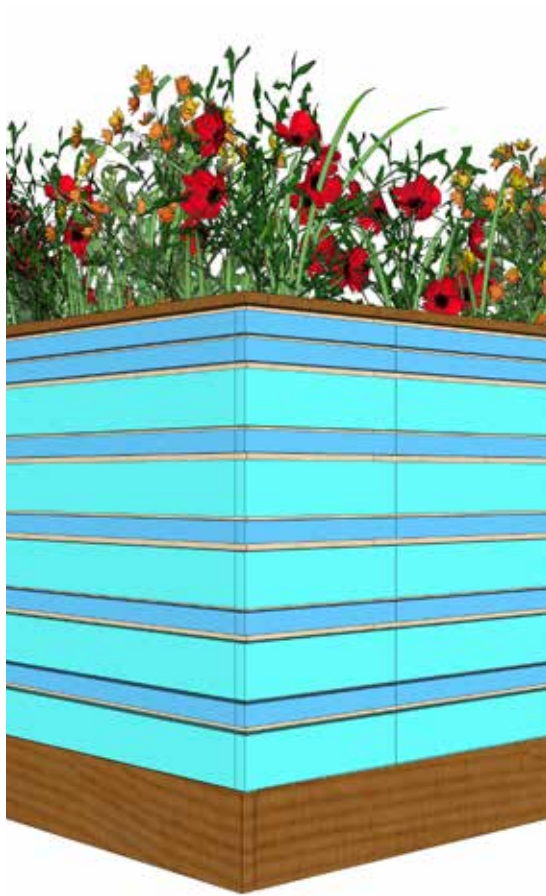

Alternating width wood planks,
painted in alternating colors.



Reclaimed Wood Planks



Metal Panels



STANDARD PEOPLE SPOT ASSEMBLY

PEOPLE SPOT ASSEMBLY

The People Spot is designed to be easily assembled and disassembled. This section demonstrates the typical construction process for a People Spot.

I. CLEAN AND PREPARE THE SITE.

A construction permit is required prior to installation. In order to ensure that no cars are parked at the site on the installation date, request that “No Parking” signs be installed as part of the permit request. Measure the site, and mark out the boundaries of the people spot to determine the location of the steel angles. Be sure to measure the curb height, and the street height at 6'-0" out, to determine any framing adjustments that will be needed.



2. PLACE STEEL ANGLES

Place the steel angles on the long sides of the people spot on the curb and street sides. The angle on the curb side should be a maximum 3" away from the curb. Bolt the angles to the pavement with 1/2" expansion bolts every 48" on center.



3. LAYOUT AND ADJUST FRAMING.

Measure and layout the 2x deck framing in separate 4' x 6' sections. Adjust the profile of the rim joists depending on the angle and curve of the street. Place all joists at 16" on center. Joists will need to change direction depending on the designed decking pattern. When preparing for framing, make sure the deck is leveled, and adjust framing to height of curb to ensure the deck platform is flush with the sidewalk at curb height.



4. APPLY DECKING

Fasten or screw the composite or wood deck boards to the framing. Depending on the design, the pattern of the deck boards will be different for every 4' x 6' section.



5. ATTACH TRANSITION STRIP

Place 48"x6" transition strips for ADA access across the gap between the steel angle and the curb. Extra blocking may be needed in the gap between the curb and angle depending on the width of the gap or the profile of the transition strip.



6. PLACE AND ATTACH PLANTERS

Planters should be assembled off site, and clad with strips of cedar. Attach the planters to the deck with 4" toggle bolts, connected to blocking on the bottom of the planters.



7. INSTALL PLANTS

Line the planters with plant liner and a minimum 12" deep soil fill. Plant your selected plants from CDOT's approved plant list. Ensure plant height requirements are not exceeded.



8. PLACE TRAFFIC SAFETY MEASURES

Place white reflective car stops 2'-0" away from the People Spot at each side of the platform. Place flexible bollards 10'-0" on center and 1'-0" away from the People Spot inside of parking lane line adjacent to traffic lanes. Apply OM3-R and OM3-L reflectors, specified for facing the direction of travel and away from the direction of travel, on the short sides of the People Spot.

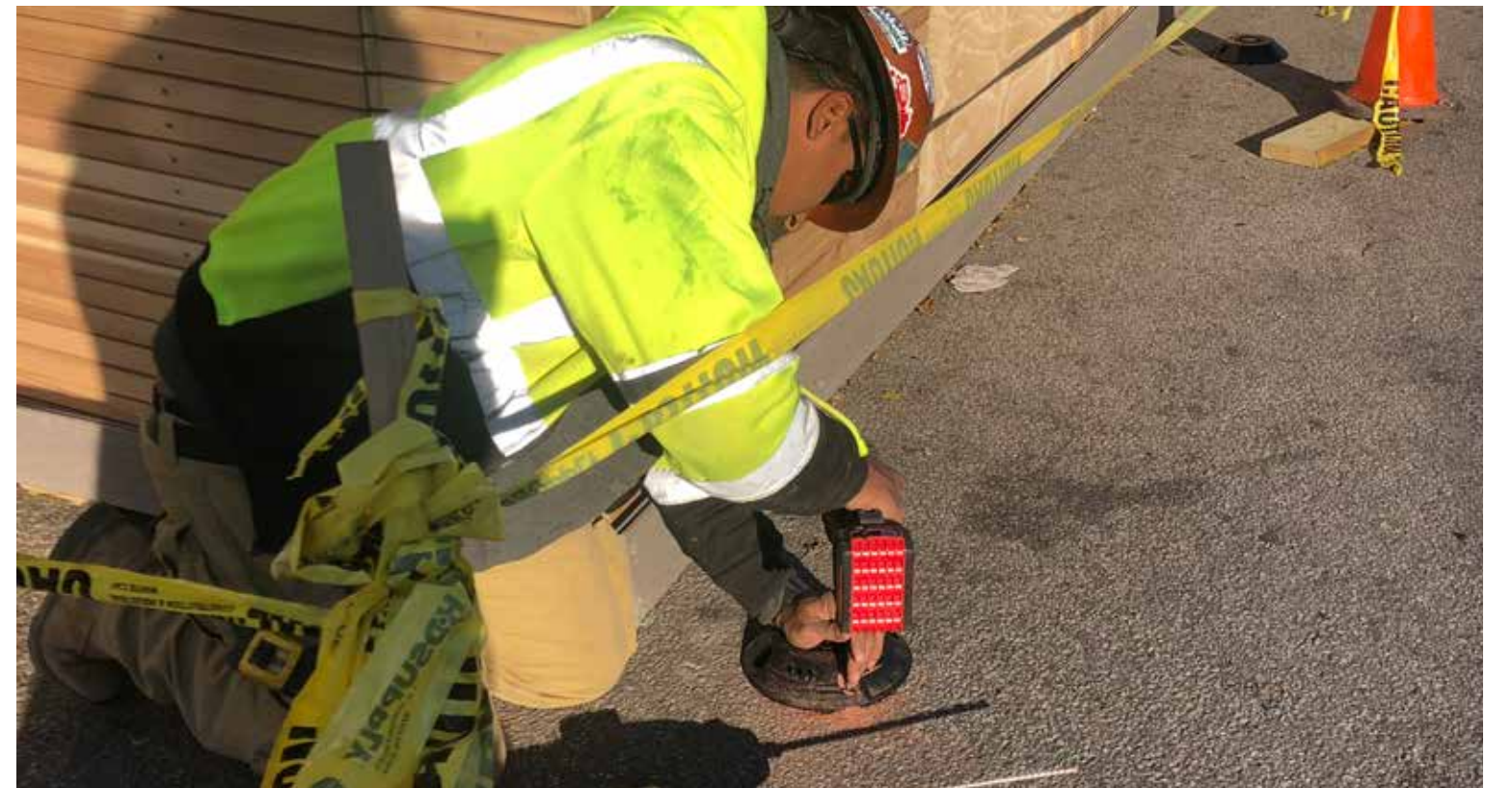

PEOPLE SPOT MAINTENANCE

People Spots are true public spaces, and require maintenance and care. This section outlines the responsibilities of the people, groups or organizations in charge of maintaining the People Spot while it is on the site.



HOW TO PROPERLY MAINTAIN THE PEOPLE SPOT

The following are maintenance responsibilities of the community partner while the People Spot is installed:

- Planters – Upkeep of planters, including debris and trash removal, weeding, plant grooming, fertilizing, pruning, mulching, watering, disease and pest control, and plant replacement.
- Litter and Debris – Remove litter and debris on, below and around the People Spot. Removal methods may include power washing and/or hand removal of trash and dirt that accumulates at/under People Spot.
- Tables and Chairs – Clean, sanitize and store tables and chairs on a daily basis.
- Vandalism - Promptly remove graffiti or remove/replace materials on the People Spot as required.
- Public Access - Ensure that the People Spot is publicly accessible and that no alcoholic beverages, cigarettes or illegal drugs are sold, given away, or consumed on the People Spot.
- Reporting - Report any damage to or misuse the People Spot, to the Chicago Department of Transportation Livable Streets Program at 312-744-5900.



